



1234 Main St., Green Bay, WI
920.430.7200
cineviz.com

LAYOUT & MATERIALS PLAN

Date: 11/12/15

Client:

Winfield Room 6 Schematics

Project Name and Number:

365 - WINFI - CROP Adventure - Room 6 - From Farm to You

Map and Overview



Summary/ Experience Description
Winfield Room 5, overviews and individual pieces for fabrication.

Technology Description
Build out, fabrication and installations.

Scope of Work
Specialty Fabrication, Signage, Wall and Floor Decal, Construction, Multi-media, AV/Data, etc.

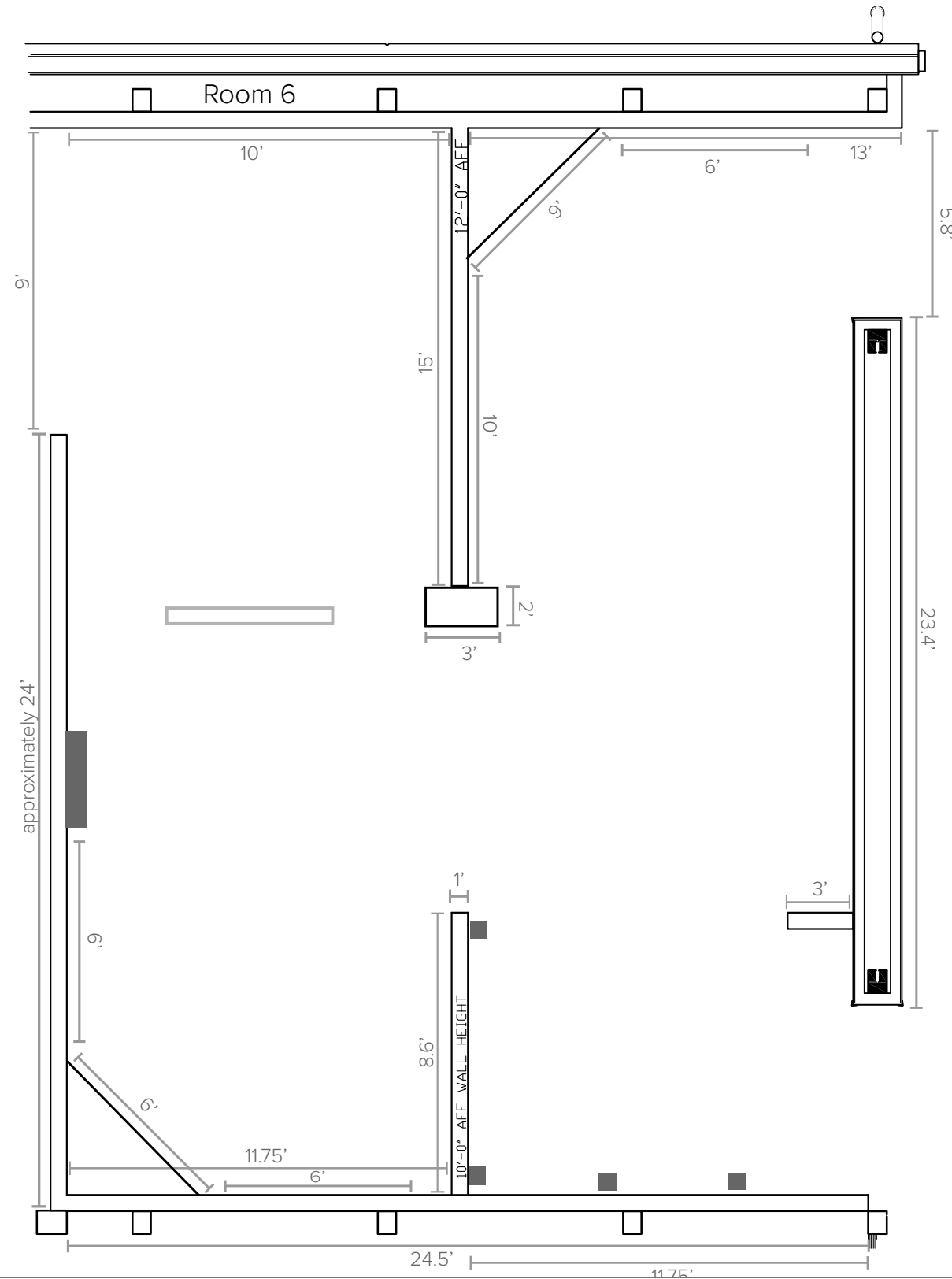

1234 Main St., Green Bay, WI
920.430.7200
cineviz.com

LAYOUT & MATERIALS PLAN

Client:
Winfield Room 6

Project Number & Name:
365 - WINFI - CROP Adventure - Room 6 - From the Farm to You

Job Number & Exhibit Description:
15410 All Schematics for Room 6

Proof Date: 11-12-15

Return Date: 11-18-15

Notes:
Overview of room 6.

Scale: NTS

Version: 1.5

Designer: sb

Skyline Wall

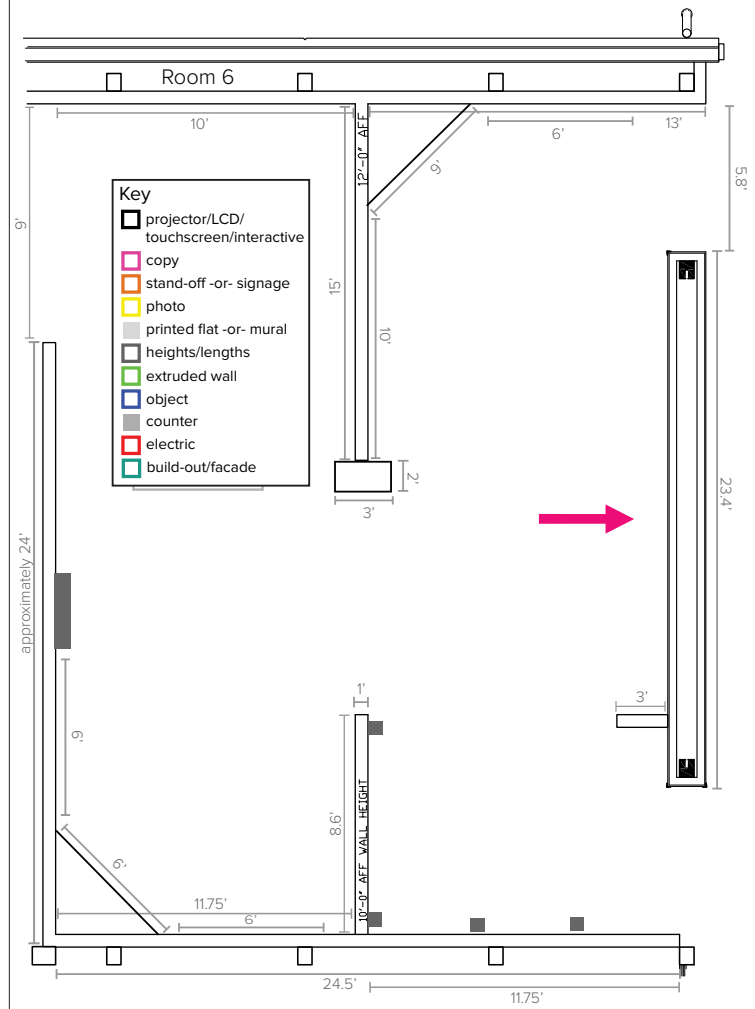

- Need to create skyline graphic imprint, 2nd story
- Need store interior graphic
- Signs fabricated or painted?

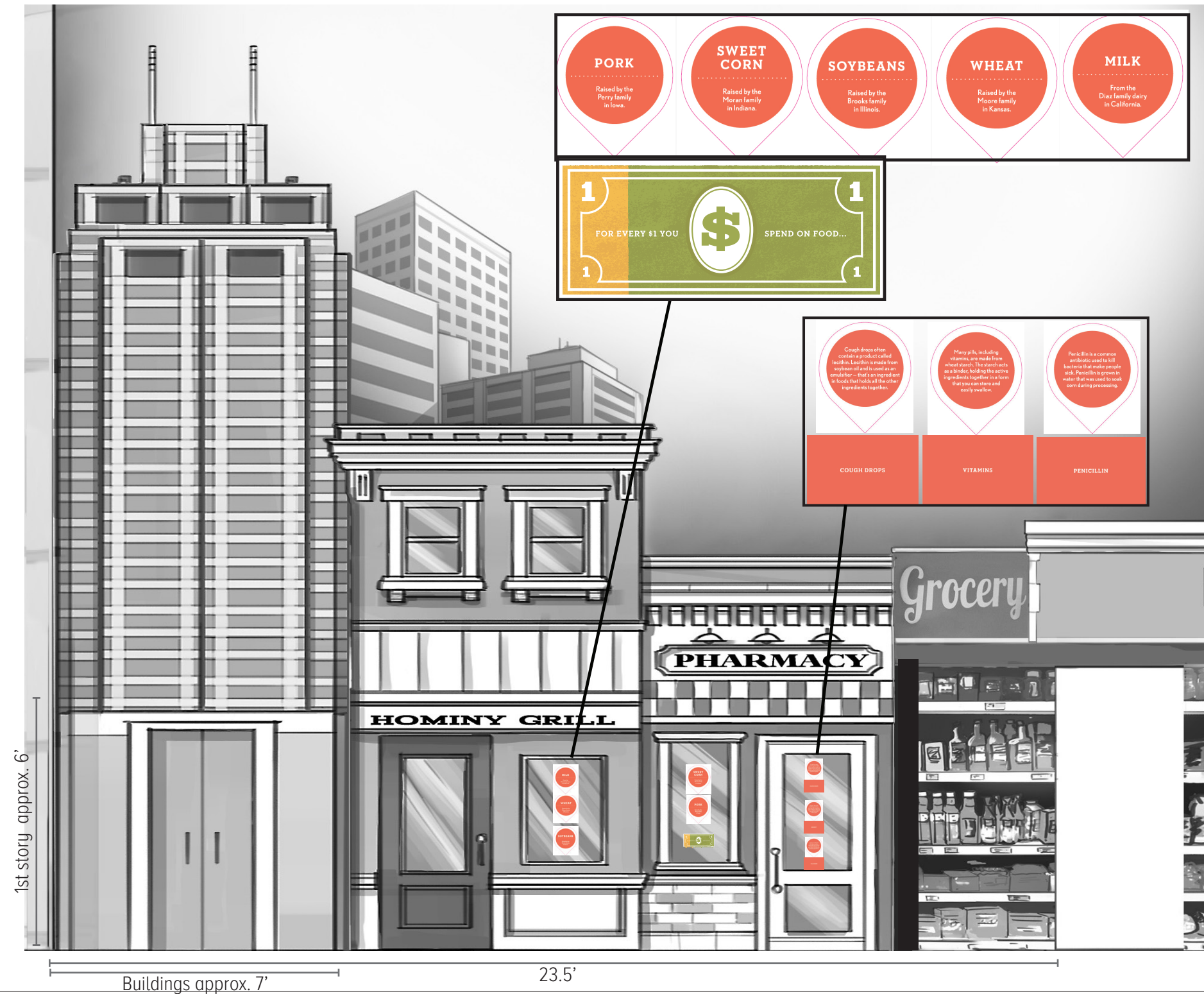

1234 Main St., Green Bay, WI
920.430.7200
cineviz.com

LAYOUT & MATERIALS PLAN

Client:
Winfield Room 6

Project Number & Name:
365 - WINFI - CROP Adventure - Room 6 - From the Farm to You

Job Number & Exhibit Description:
15410 All Schematics for Room 6

Proof Date: 11-12-15

Return Date: 11-18-15

Notes:

- Materials for fabrication for the first story could include anything practical (wood, drywall, fiberglass or metal.)
- Second story and background would be scenery/mural painting. Signs may be painted as well.
- Height of first story will be arbitrary or taller than the height of graphic on the store interior wall.
- Signs are for the windows and will be provided separately. (We have no info on their actual placement.)
- Buildings are approx. 7' wide and 1st story approx. 6' tall.

Summary/ Experience Description

Winfield Room 5, overviews and individual pieces for fabrication.

Technology Description

Build out, fabrication and installations.

Scope of Work

Specialty Fabrication, Signage, Wall and Floor Decal, Construction, Multi-media, AV/Data, etc.

Scale: NTS

Version: 1.5

Designer: sb

Skyline Wall

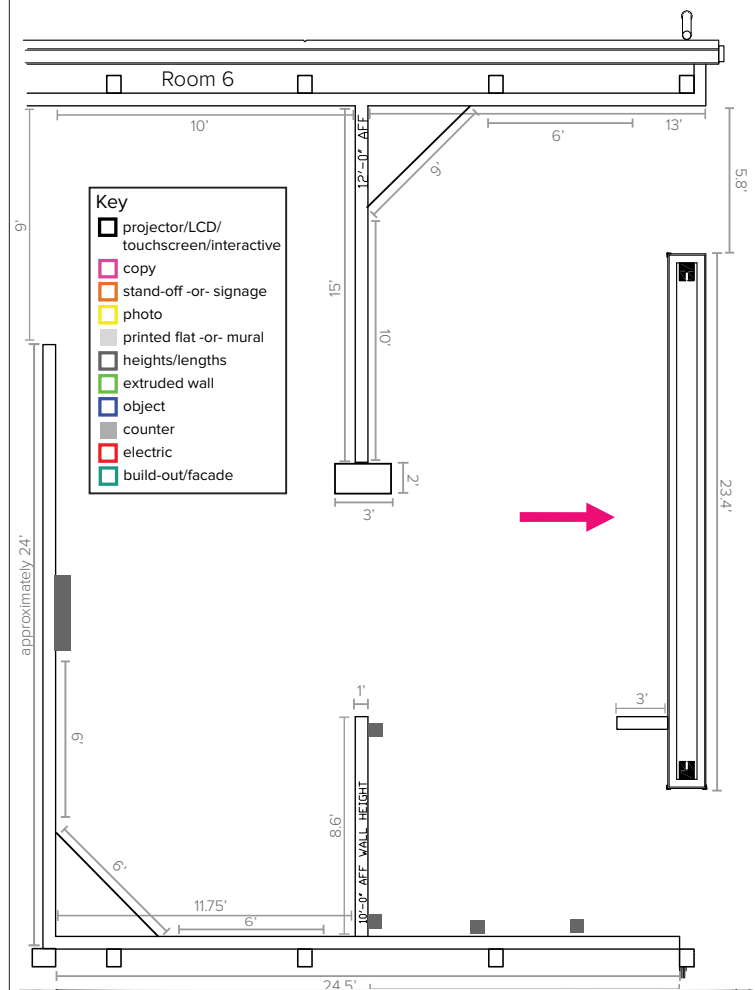

- Need to create skyline mural
- Need store interior graphic

Skyscraper - left side no longer wraps around edge of the wall, and is flat.

Approx. 6'

Grill and pharmacy are fabricated/build-out

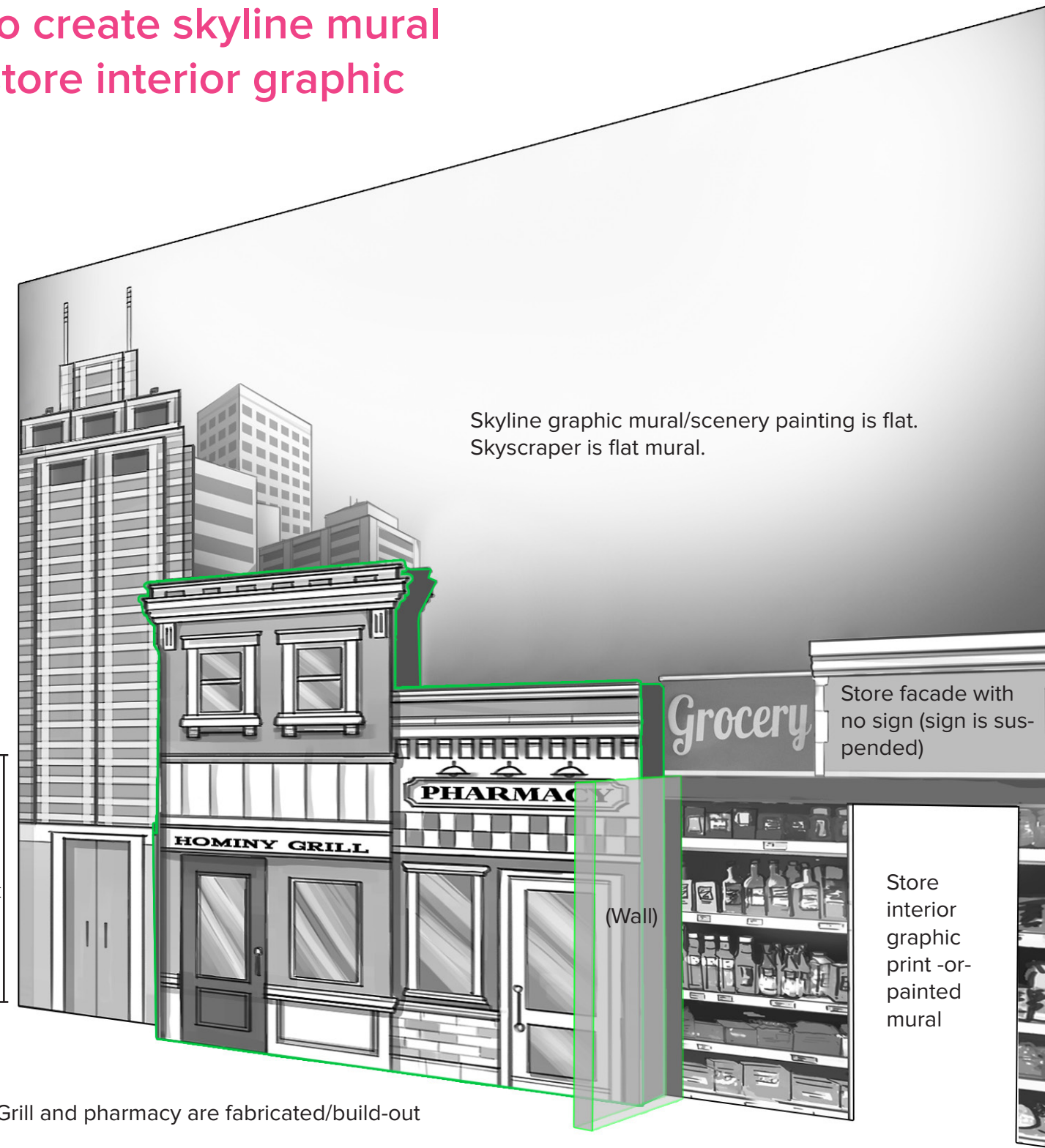

Summary/ Experience Description

Winfield Room 5, overviews and individual pieces for fabrication.

Technology Description

Build out, fabrication and installations.

Scope of Work

Specialty Fabrication, Signage, Wall and Floor Decal, Construction, Multi-media, AV/Data, etc.



1234 Main St., Green Bay, WI
920.430.7200
cineviz.com

LAYOUT & MATERIALS PLAN

Client:
Winfield Room 6

Project Number & Name:
365 - WINFI - CROP Adventure - Room 6 - From the Farm to You

Job Number & Exhibit Description:
15410 All Schematics for Room 6

Proof Date: 11-12-15

Return Date: 11-18-15

Notes:

- Fabrication for the first story would include anything practical (wood, drywall, fiberglass or metal.)
- Second story, all skyscraper, and background would be scenery/mural painting.
- Height of first story will be arbitrary or taller than the height of graphic on the store interior wall.
- Buildings 1st stories are approximately 7' wide, 6' tall and 1' deep.
- The fabricated wall is approximately 1.5' deep.

Scale: NTS

Version: 1.5

Designer: sb

Skyline Wall

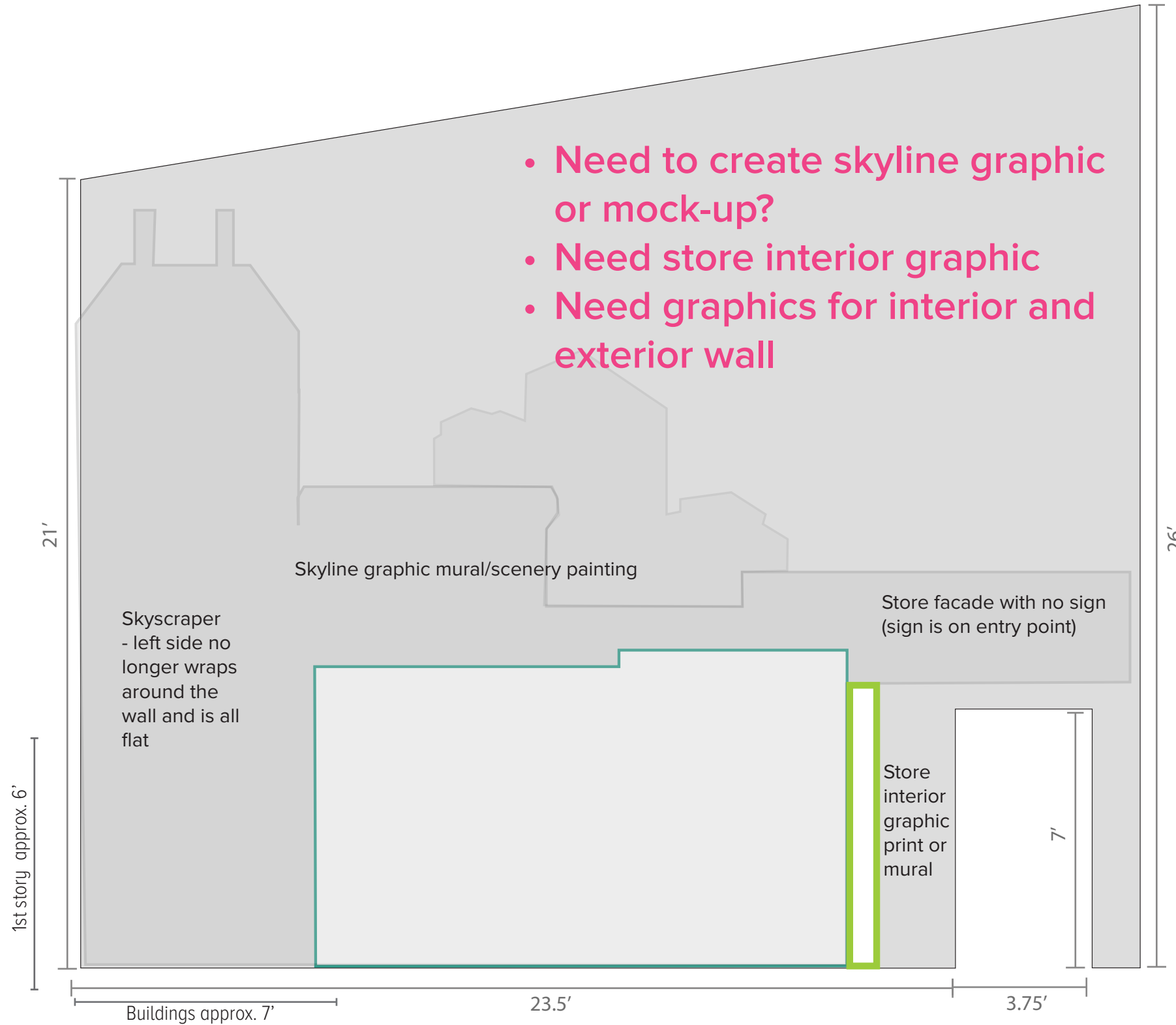
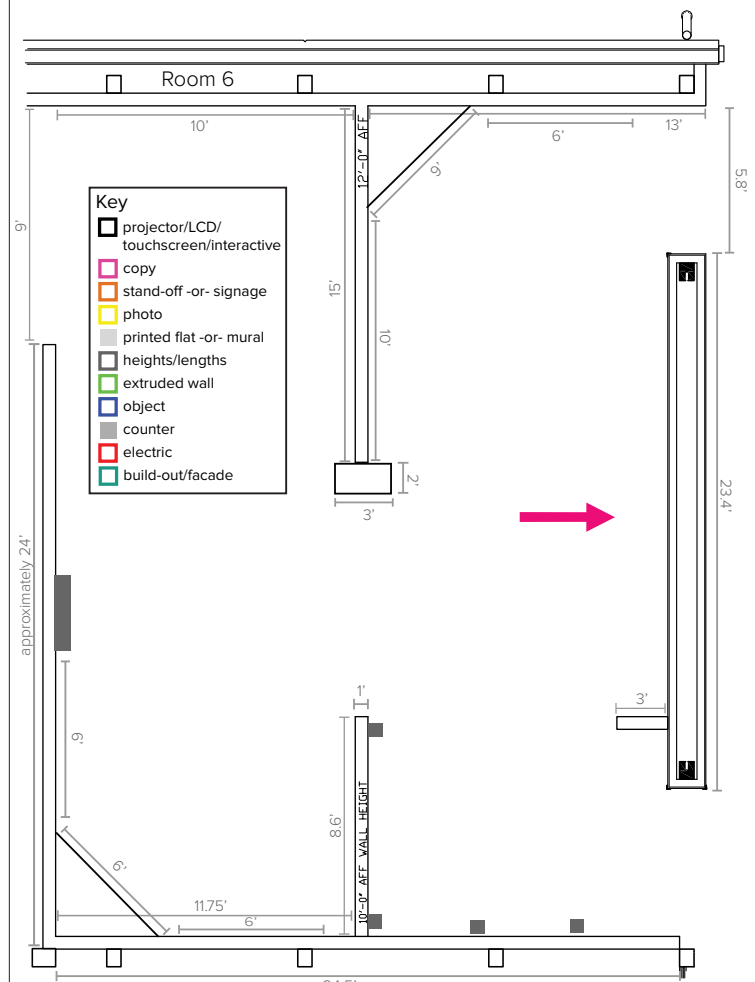

- Need to create skyline graphic or mock-up?
- Need store interior graphic
- Need graphics for interior and exterior wall



1234 Main St., Green Bay, WI
920.430.7200
cineviz.com

LAYOUT & MATERIALS PLAN

Client:
Winfield Room 6

Project Number & Name:
365 - WINFI - CROP Adventure - Room 6 - From the Farm to You

Job Number & Exhibit Description:
15410 All Schematics for Room 6

Proof Date: 11-12-15

Return Date: 11-18-15

Notes:

- Materials for fabrication for the first story would include anything practical (wood, drywall, fiberglass or metal.) Second story and background would be scenery/mural painting.
- Height of first story will be arbitrary or taller than the height of graphic on the store interior wall.
- Buildings, 1st story, are approximately 7' wide, 6' tall and 1' deep.
- The fabricated wall is approximately 1' wide and 1.5' deep.

Summary/ Experience Description

Winfield Room 5, overviews and individual pieces for fabrication.

Technology Description

Build out, fabrication and installations.

Scope of Work

Specialty Fabrication, Signage, Wall and Floor Decal, Construction, Multi-media, AV/Data, etc.

Scale: NTS

Version: 1.5

Designer: sb

Skyline Wall

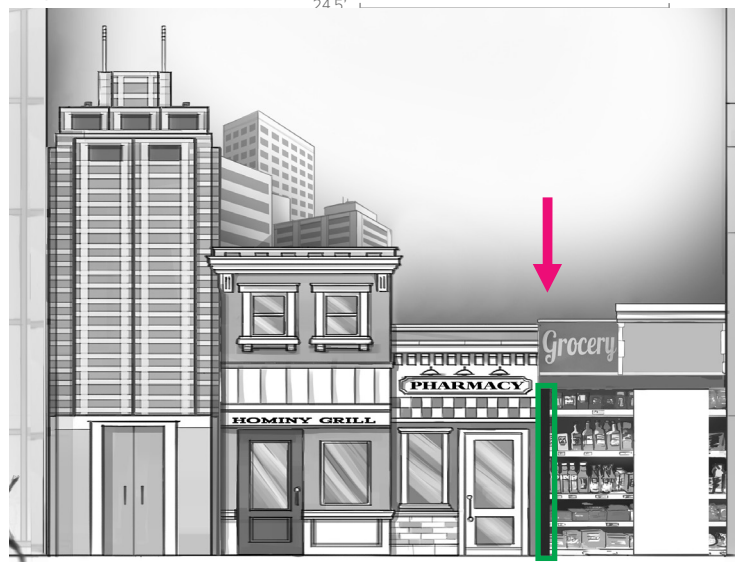
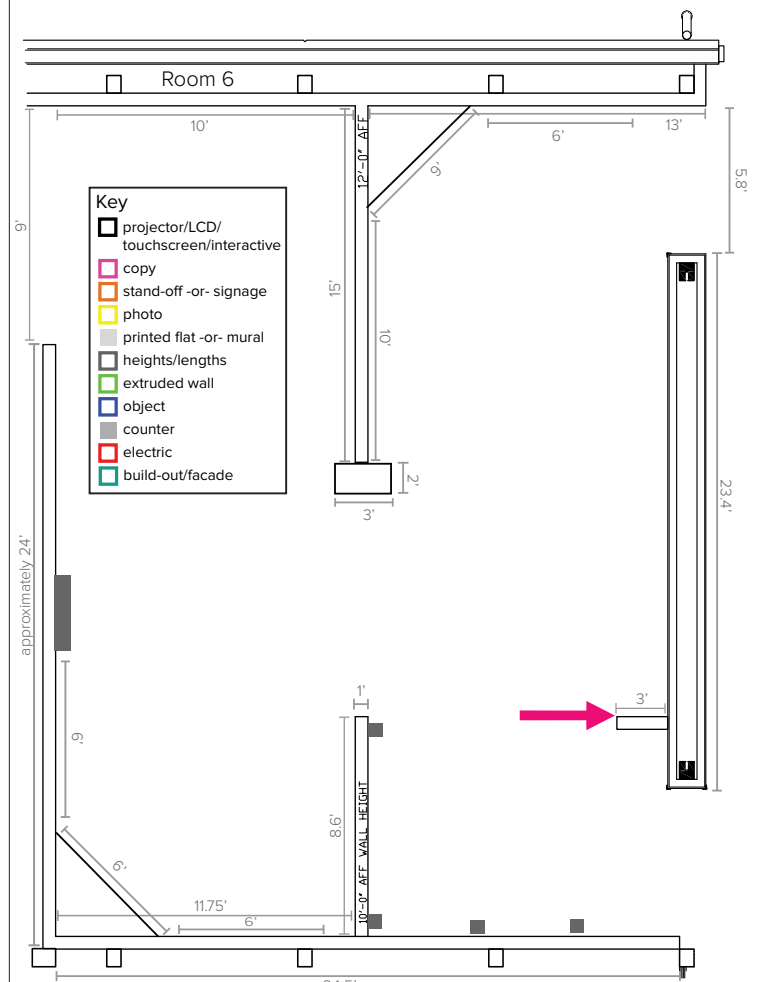

- Who is providing store interior graphic/design/mural?
- Mural contents should coordinate with the items on shelves.

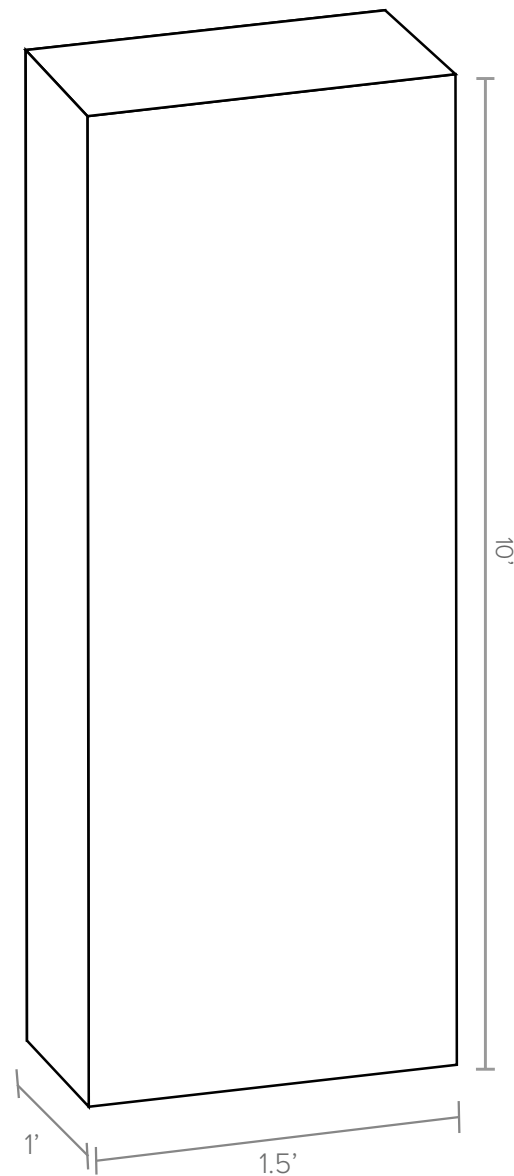

Outside--same treatment as front of store

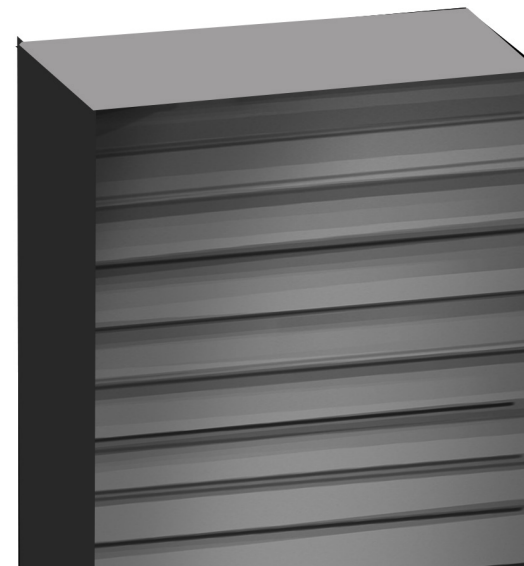

Inside--same treatment as inside of the store

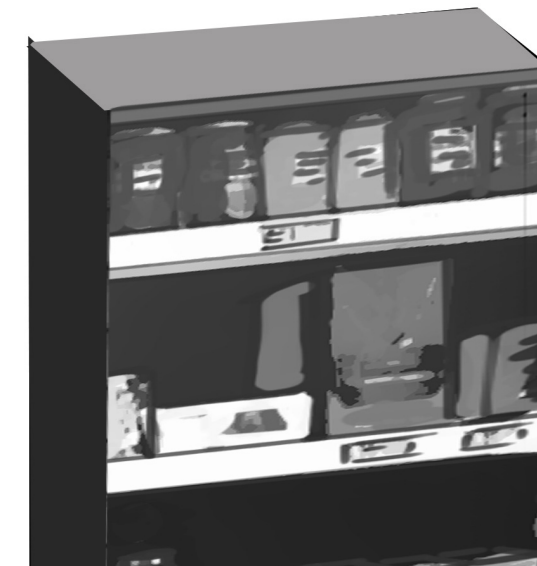

1234 Main St., Green Bay, WI
920.430.7200
cineviz.com

LAYOUT & MATERIALS PLAN

Client:
Winfield Room 6

Project Number & Name:
365 - WINFI - CROP Adventure - Room 6 - From the Farm to You

Job Number & Exhibit Description:
15410 All Schematics for Room 6

Proof Date: 11-12-15

Return Date: 11-18-15

Notes:

- Materials for fabrication (wood, drywall, fiberglass or metal.)
- Height is approximately 10' or whatever works well with the Pharmacy fabrication.
- The treatment to the outside and inside of this wall should be the same as the face of the hanging sign and interior of stores.

Summary/ Experience Description

Winfield Room 5, overviews and individual pieces for fabrication.

Technology Description

Build out, fabrication and installations.

Scope of Work

Specialty Fabrication, Signage, Wall and Floor Decal, Construction, Multi-media, AV/Data, etc.

Scale: NTS

Version: 1.5

Designer: sb

Skyline Wall

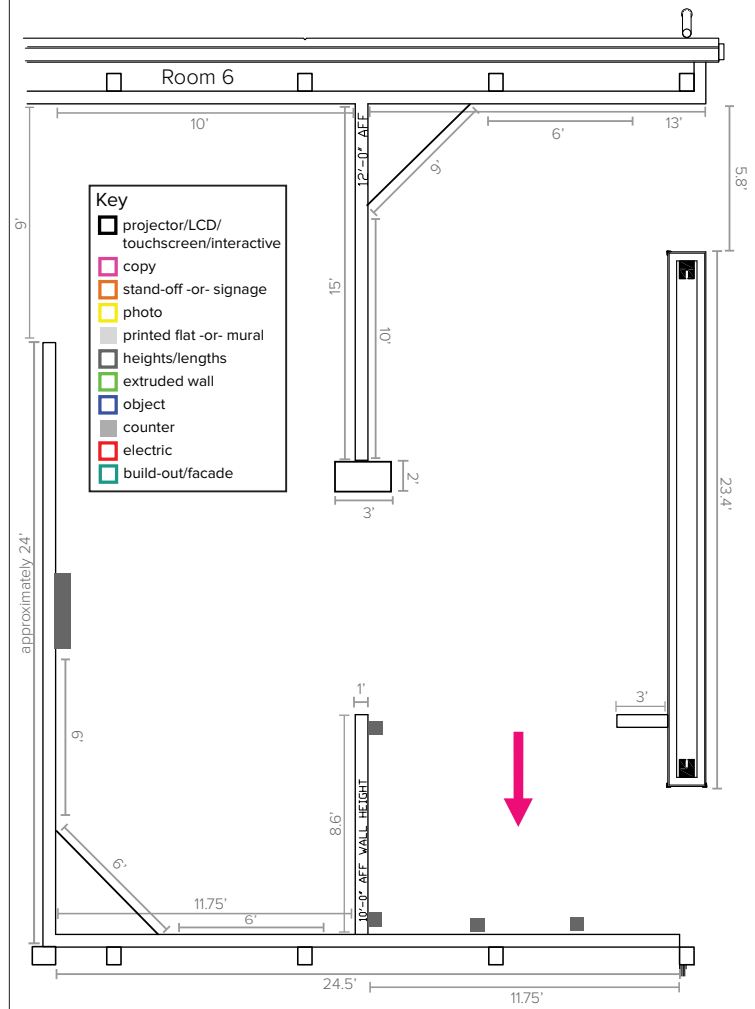

- Need all store content concepts--what goes on the shelves?
- Who decides the shelf color?



1234 Main St., Green Bay, WI
920.430.7200
cineviz.com

LAYOUT & MATERIALS PLAN

Client:
Winfield Room 6

Project Number & Name:
365 - WINFI - CROP Adventure - Room 6 - From the Farm to You

Job Number & Exhibit Description:
15410 All Schematics for Room 6

Proof Date: 11-12-15

Return Date: 11-18-15

Notes:

- Shelves are build-outs. In white or in one of the style guide pantones.
- The store name is to be fabricated and hanging where the wall used to be.
- The walls will be painted or imprint.

Summary/ Experience Description

Winfield Room 5, overviews and individual pieces for fabrication.

Technology Description

Build out, fabrication and installations.

Scope of Work

Specialty Fabrication, Signage, Wall and Floor Decal, Construction, Multi-media, AV/Data, etc.

Scale: NTS

Version: 1.5

Designer: sb

Skyline Wall

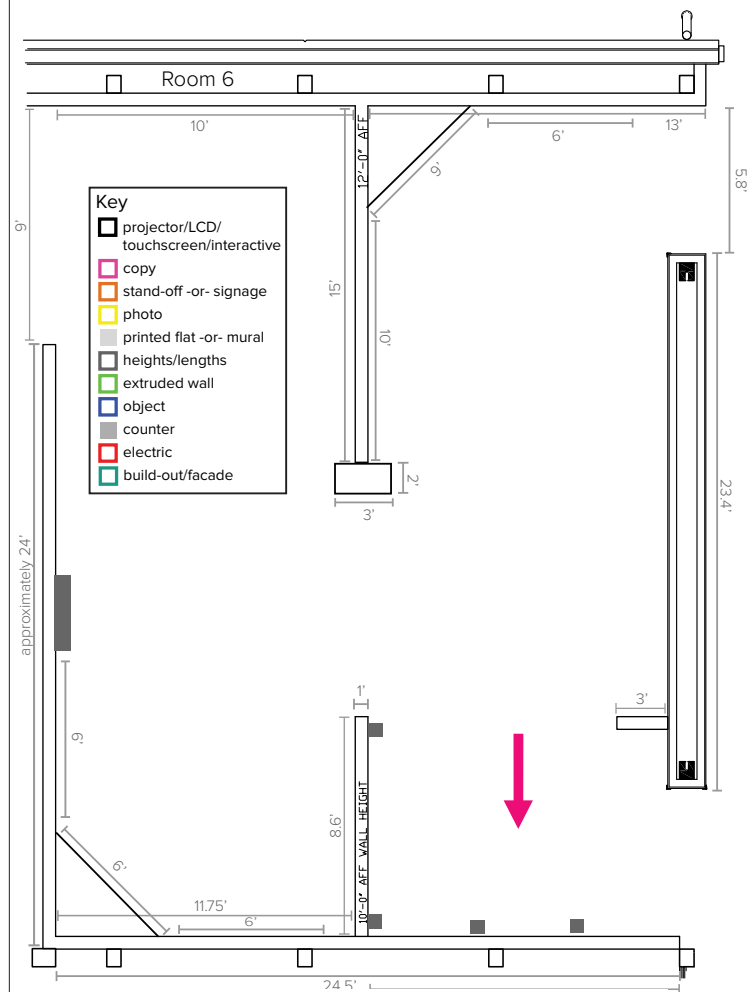

Wall graphic mural/scenery painting

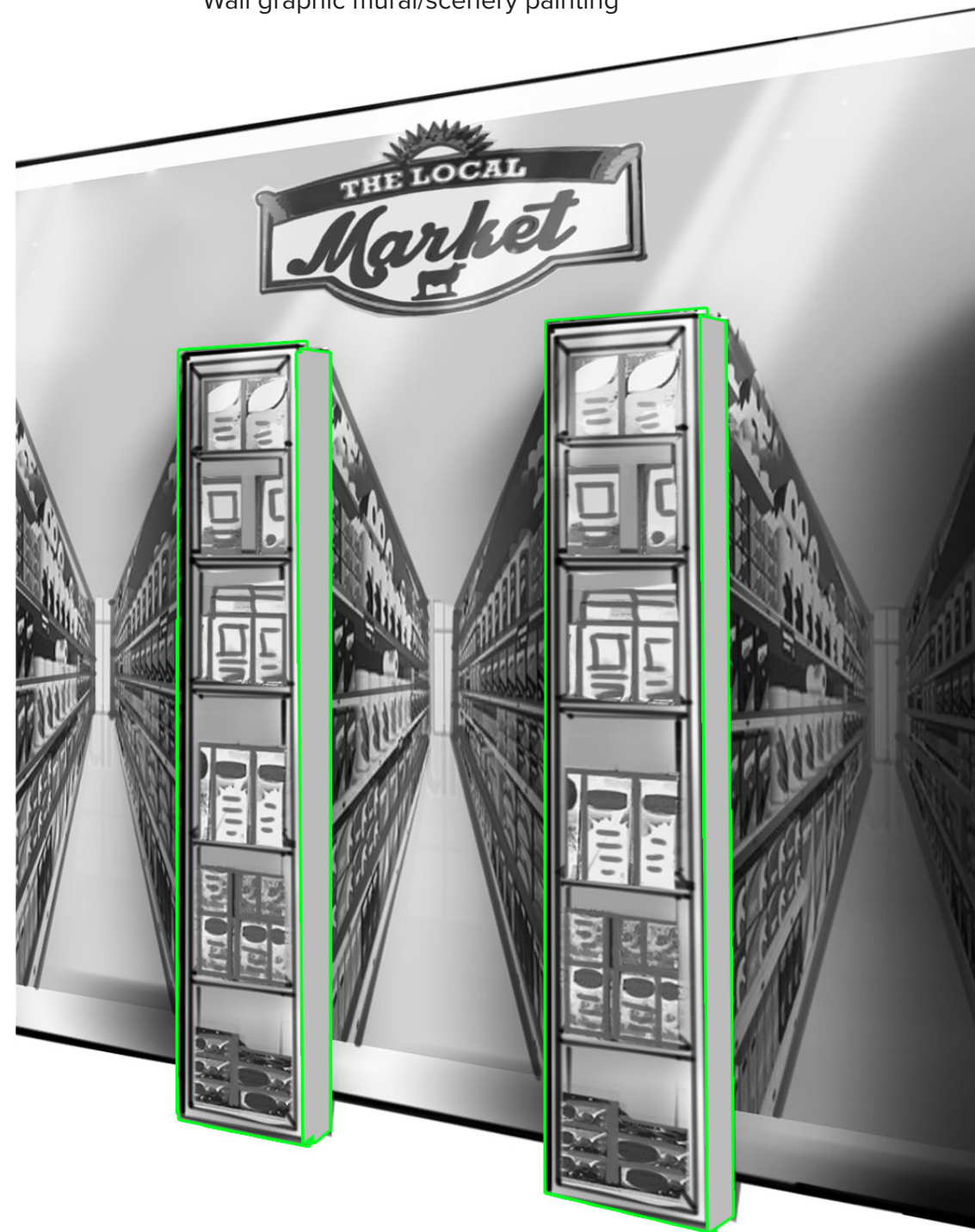

- Need all store contents concepts for things on shelves
- Or art needs to be provided if items on shelves are cut outs
- Who chooses the color of shelves?

Shelves are extruded

Items on shelves are fabricated or cutouts



1234 Main St., Green Bay, WI
920.430.7200
cineviz.com

LAYOUT & MATERIALS PLAN

Client:
Winfield Room 6

Project Number & Name:
365 - WINFI - CROP Adventure - Room 6 - From the Farm to You

Job Number & Exhibit Description:
15410 All Schematics for Room 6

Proof Date: 11-12-15

Return Date: 11-18-15

Notes:

- Shelves are build-outs. In white or in one of the style guide pantones.
- The walls will be painted or imprint, like store aisles.

Summary/ Experience Description

Winfield Room 5, overviews and individual pieces for fabrication.

Technology Description

Build out, fabrication and installations.

Scope of Work

Specialty Fabrication, Signage, Wall and Floor Decal, Construction, Multi-media, AV/Data, etc.

Scale: NTS

Version: 1.5

Designer: sb

Skyline Wall

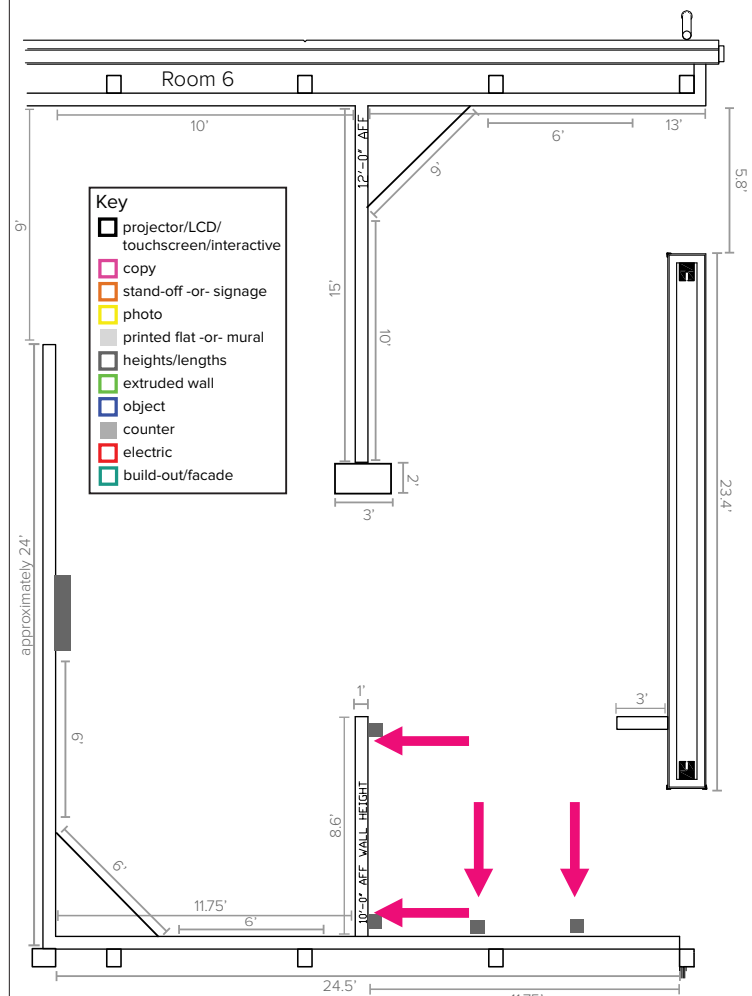

Fabricated shelves -- 2 pieces.
2 shelves placed along
back wall at regular intervals
and at the "end of the aisles."

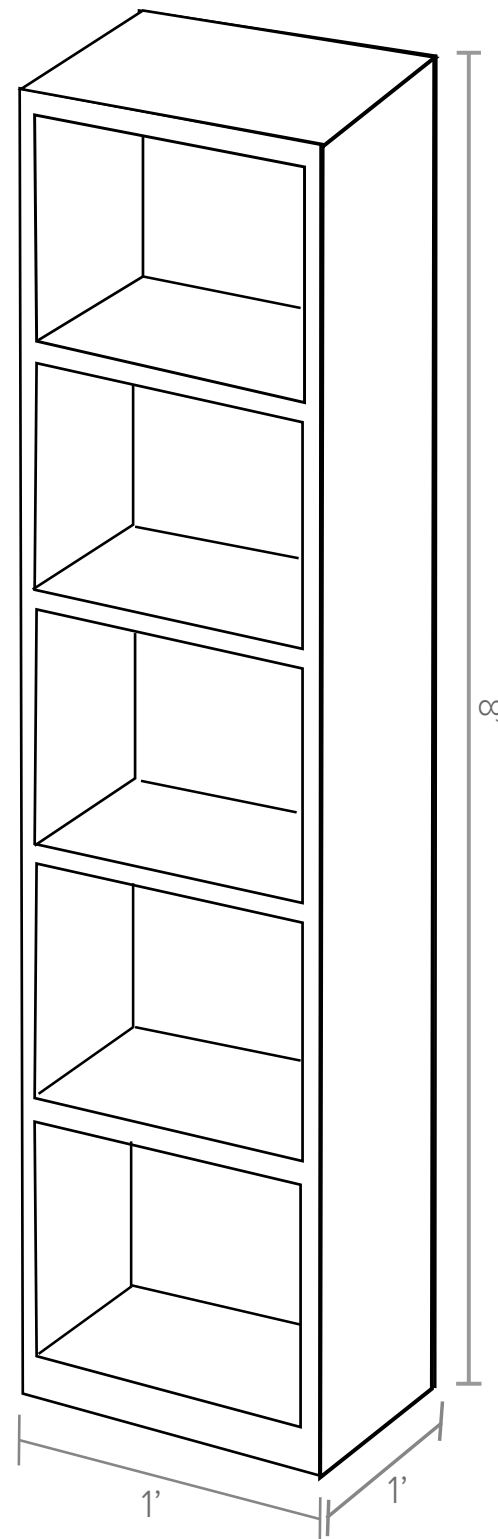

- Need all contents concept-ed
- Need to pick a color
- Need items on shelves--art or fabrication

Shelves are extruded
from the wall.
Items on shelves are
fabricated or cutouts.

Summary/ Experience Description

Winfield Room 5, overviews and individual pieces for fabrication.

Technology Description

Build out, fabrication and installations.

Scope of Work

Specialty Fabrication, Signage, Wall and Floor Decal, Construction, Multi-media, AV/Data, etc.



1234 Main St., Green Bay, WI
920.430.7200
cineviz.com

LAYOUT & MATERIALS PLAN

Client:
Winfield Room 6

Project Number & Name:
365 - WINFI - CROP Adventure - Room 6 - From the Farm to You

Job Number & Exhibit Description:
15410 All Schematics for Room 6

Proof Date: 11-12-15

Return Date: 11-18-15

Notes:

- Materials for fabrication for the shelving would include anything practical (wood, drywall, fiberglass or metal.)
- Height of shelves should match the doors.
- Color will be white or any of the style guide pantone colors.

Scale: NTS

Version: 1.5

Designer: sb

Market Entrance Fake Facade Wall

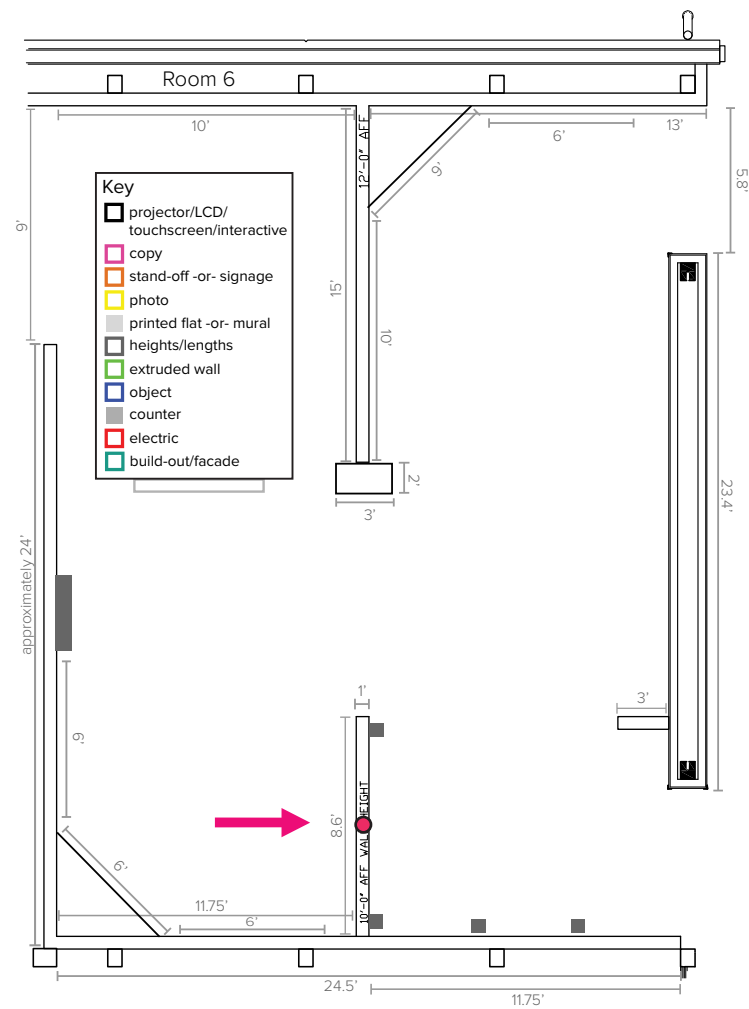

- Fabricated market entrance is now hanging sign, painted or imprint?
- Sign (letters) needs to be provided



1234 Main St., Green Bay, WI
920.430.7200
cineviz.com

LAYOUT & MATERIALS PLAN

Client:
Winfield Room 6

Project Number & Name:
365 - WINFI - CROP Adventure - Room 6 - From the Farm to You

Job Number & Exhibit Description:
15410 All Schematics for Room 6

Proof Date: 11-12-15

Return Date: 11-18-15

Notes:

- Materials for overhang fabrication for the sign would include anything practical (wood, dry-wall, fiberglass or metal.)
- Graphic or painted imprinted siding with fabricated overhang/awning and extruded letter sign.

Summary/ Experience Description

Winfield Room 5, overviews and individual pieces for fabrication.

Technology Description

Build out, fabrication and installations.

Scope of Work

Specialty Fabrication, Signage, Wall and Floor Decal, Construction, Multi-media, AV/Data, etc.

Scale: NTS

Version: 1.5

Designer: sb

Market Entrance Fake Facade Wall

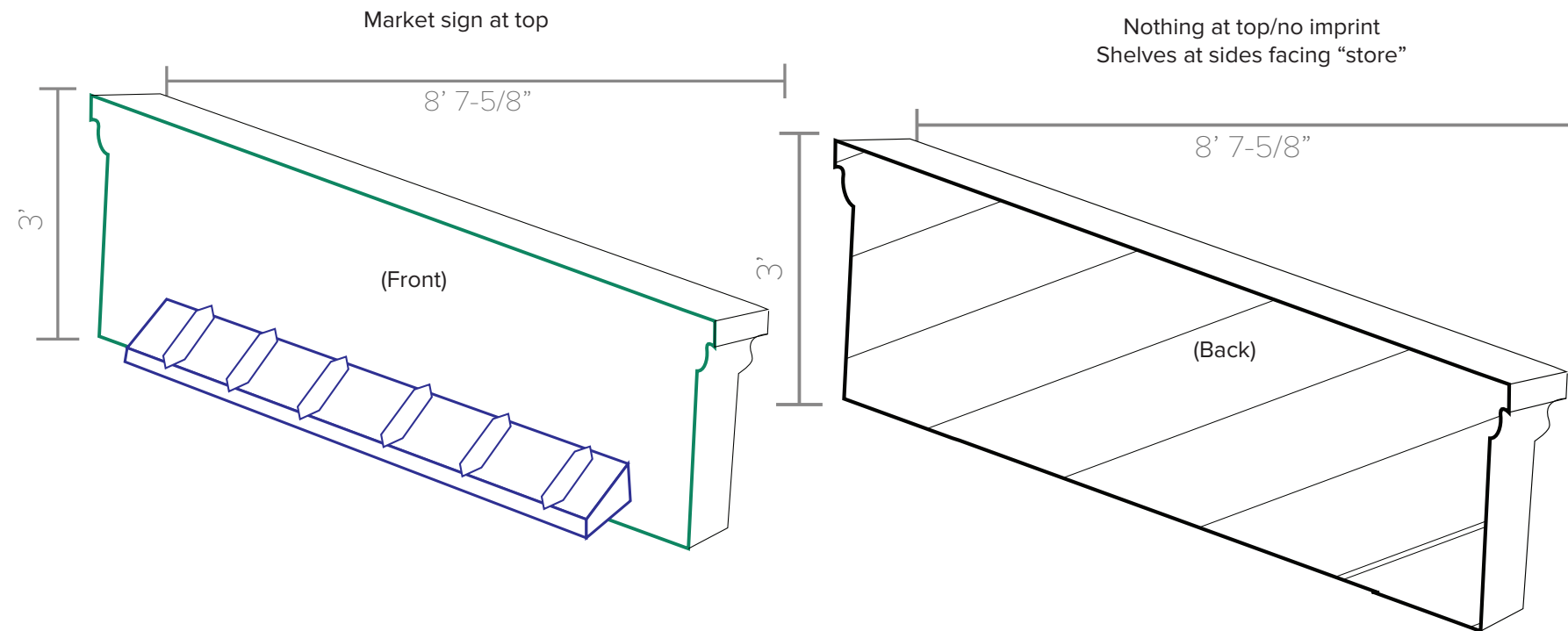
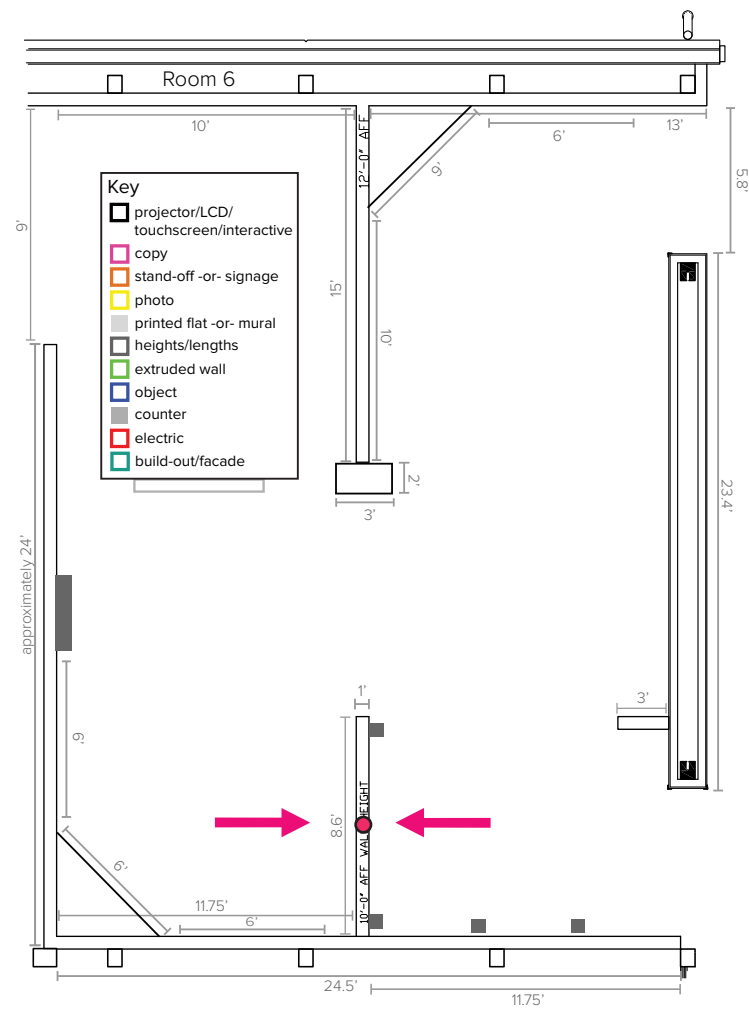

• Fabricated -- need sign art (letters)

• Need exterior sign ...

• Need interior store graphic or painted scene



1234 Main St., Green Bay, WI
920.430.7200
cineviz.com

LAYOUT & MATERIALS PLAN

Client:
Winfield Room 6

Project Number & Name:
365 - WINFI - CROP Adventure - Room 6 - From the Farm to You

Job Number & Exhibit Description:
15410 All Schematics for Room 6

Proof Date: 11-12-15

Return Date: 11-18-15

Notes:

- This is suspended for the bottom to hang at door height or the height of the shelves.
- Materials for fabrication for the would include anything practical (wood, drywall, fiberglass or metal.)

Summary/ Experience Description

Winfield Room 5, overviews and individual pieces for fabrication.

Technology Description

Build out, fabrication and installations.

Scope of Work

Specialty Fabrication, Signage, Wall and Floor Decal, Construction, Multi-media, AV/Data, etc.

Scale: NTS

Version: 1.5

Designer: sb

Farmington Facades and Truck Fabrications

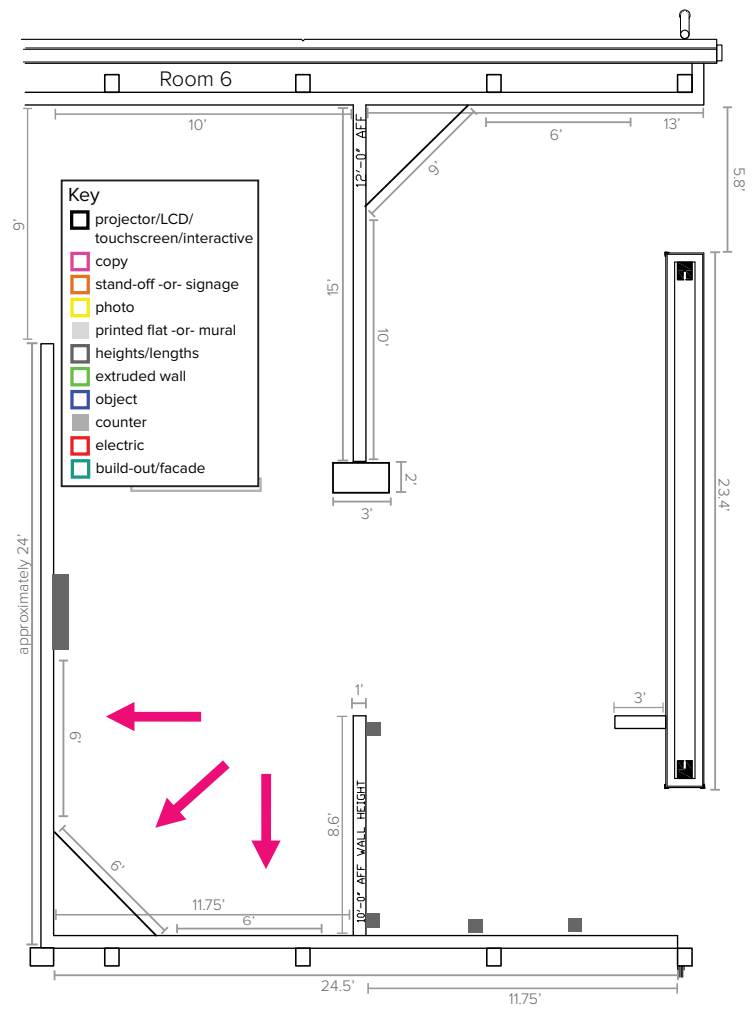

LAYOUT & MATERIALS PLAN

Client:
Winfield Room 6

Project Number & Name:
365 - WINFI - CROP Adventure - Room 6 - From the Farm to You

Job Number & Exhibit Description:
15410 All Schematics for Room 6

Proof Date: 11-12-15

Return Date: 11-18-15

Notes:

- Farmington sign is suspended for the bottom to hang at door height.
- Materials for truck fabrication for the would include anything practical (wood, drywall, fiberglass or metal.)

Summary/ Experience Description
 Winfield Room 5, overviews and individual pieces for fabrication.

Technology Description
 Build out, fabrication and installations.

Scope of Work
 Specialty Fabrication, Signage, Wall and Floor Decal, Construction, Multi-media, AV/Data, etc.

Scale: NTS
 Version: 1.5
 Designer: sb

Fieldstone Mall Facades

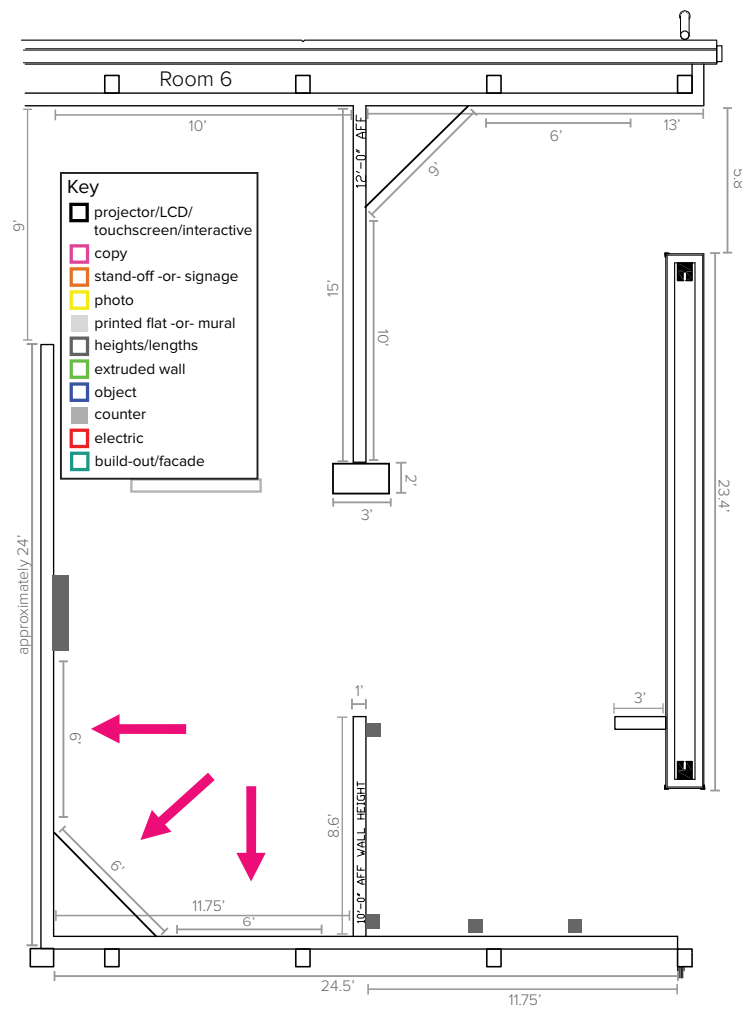

- Top silhouette-is it cut in the pattern of the building?
- Store signs needs to be provided
- Are the artifacts in the windows or outside the buildings? Or cut outs?
- Doors and windows approx. 3' wide



Signs for windows

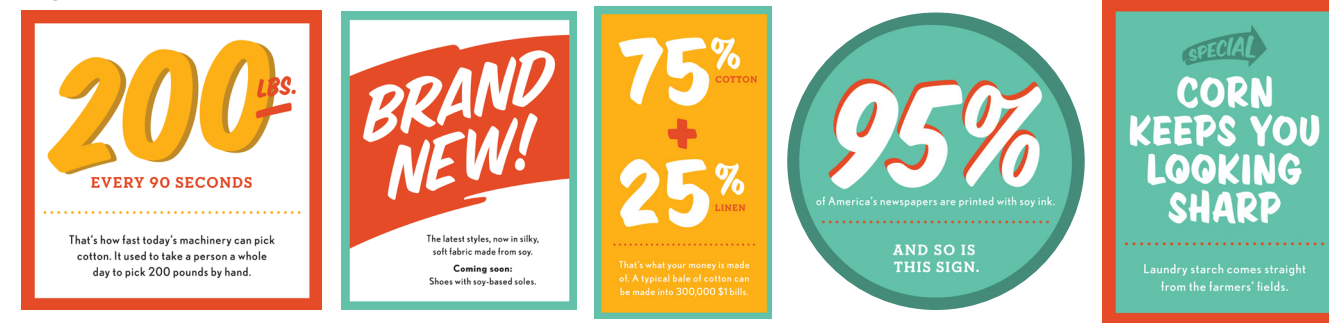

Summary/ Experience Description

Winfield Room 5, overviews and individual pieces for fabrication.

Technology Description

Build out, fabrication and installations.

Scope of Work

Specialty Fabrication, Signage, Wall and Floor Decal, Construction, Multi-media, AV/Data, etc.



1234 Main St., Green Bay, WI
920.430.7200
cineviz.com

LAYOUT & MATERIALS PLAN

Client:
Winfield Room 6

Project Number & Name:
365 - WINFI - CROP Adventure - Room 6 - From the Farm to You

Job Number & Exhibit Description:
15410 All Schematics for Room 6

Proof Date: 11-12-15

Return Date: 11-18-15

Notes:

- Materials for fabrication for the would include anything practical (wood, drywall, fiberglass or metal.)
- 1st story fabricated, second story painted or imprint. 1st story approximately 6' tall and approx. 7' wide.
- 2nd story is scenery painting.
- Center building on an angled built wall, in the corner.
- Doors and windows approximately 3' wide.

Scale: NTS

Version: 1.5

Designer: sb

Fieldstone Mall Facades

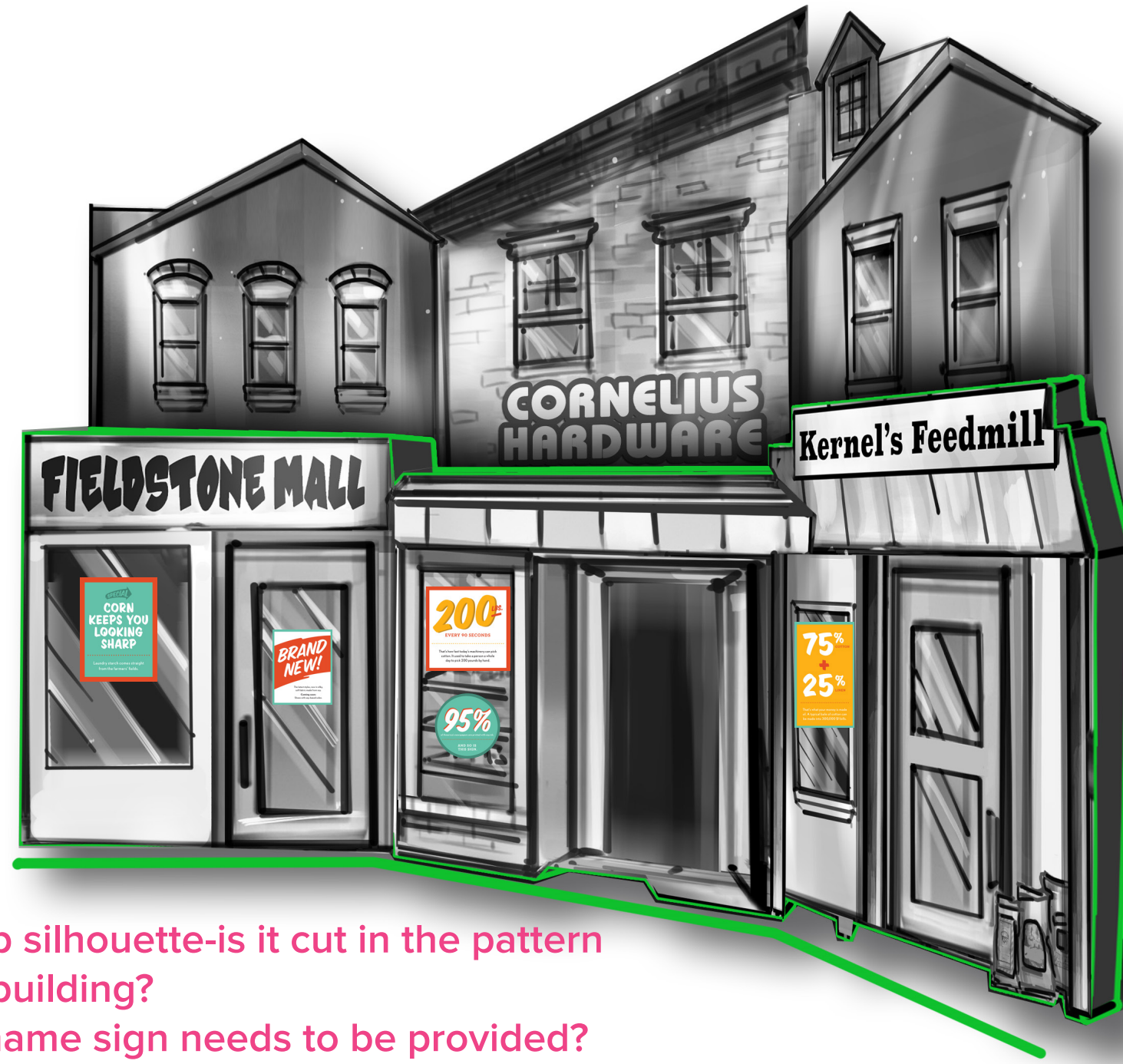
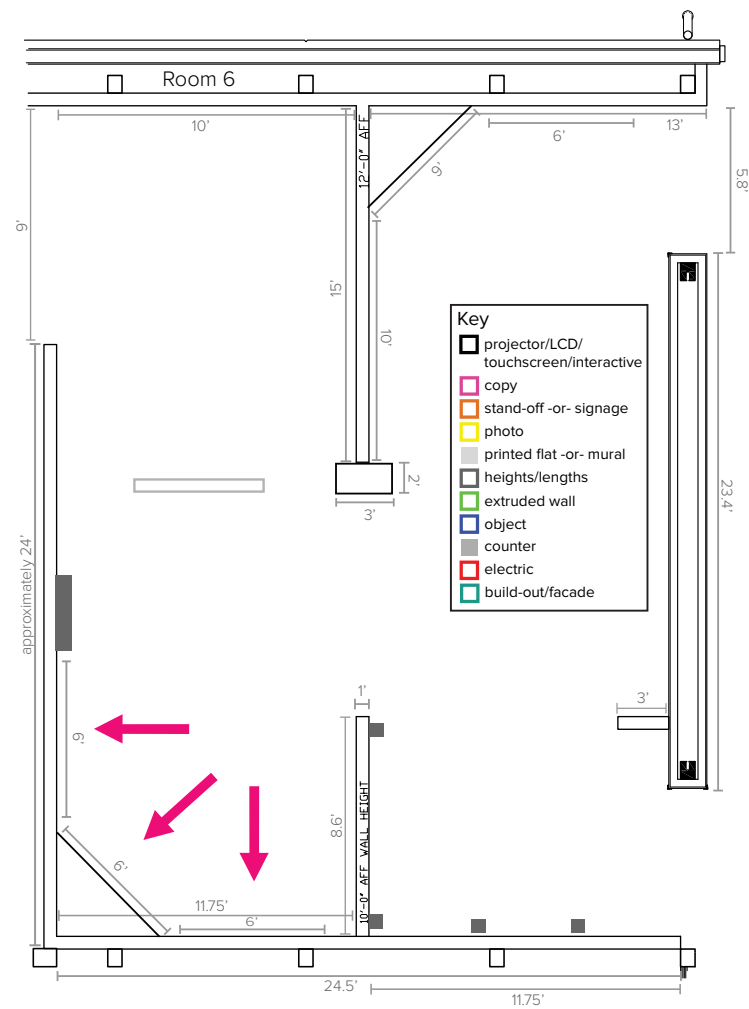

- The top silhouette-is it cut in the pattern of the building?
- Store name sign needs to be provided?
- Are the artifacts in the windows or outside the buildings?



1234 Main St., Green Bay, WI
920.430.7200
cineviz.com

LAYOUT & MATERIALS PLAN

Client:
Winfield Room 6

Project Number & Name:
365 - WINFI - CROP Adventure - Room 6 - From the Farm to You

Job Number & Exhibit Description:
15410 All Schematics for Room 6

Proof Date: 11-12-15

Return Date: 11-18-15

Notes:

- Materials for fabrication for the would include anything practical (wood, drywall, fiberglass or metal.)
- 1st story fabricated.
- 2nd story is scenery painting.
- Center building on an angled built wall, in the corner.
- Doors and windows approximately 3' wide.
- Fabrication is approx. 1' deep.

Summary/ Experience Description

Winfield Room 5, overviews and individual pieces for fabrication.

Technology Description

Build out, fabrication and installations.

Scope of Work

Specialty Fabrication, Signage, Wall and Floor Decal, Construction, Multi-media, AV/Data, etc.

Scale: NTS

Version: 1.5

Designer: sb

Farmington Facades

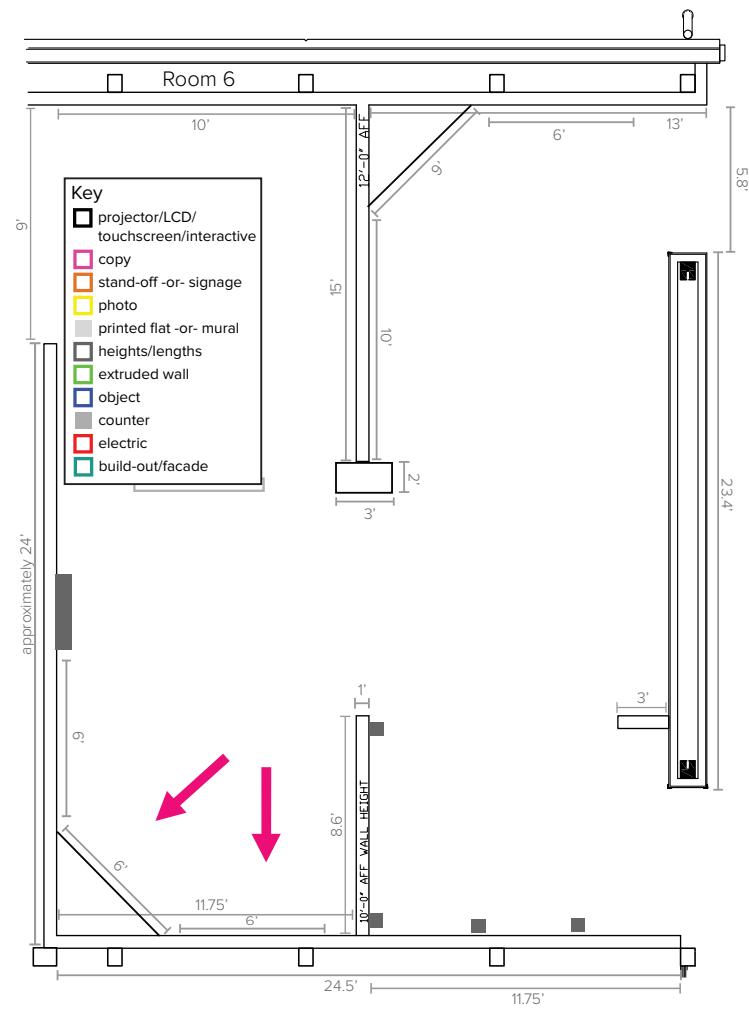

The market is to the left of the storefront wall.

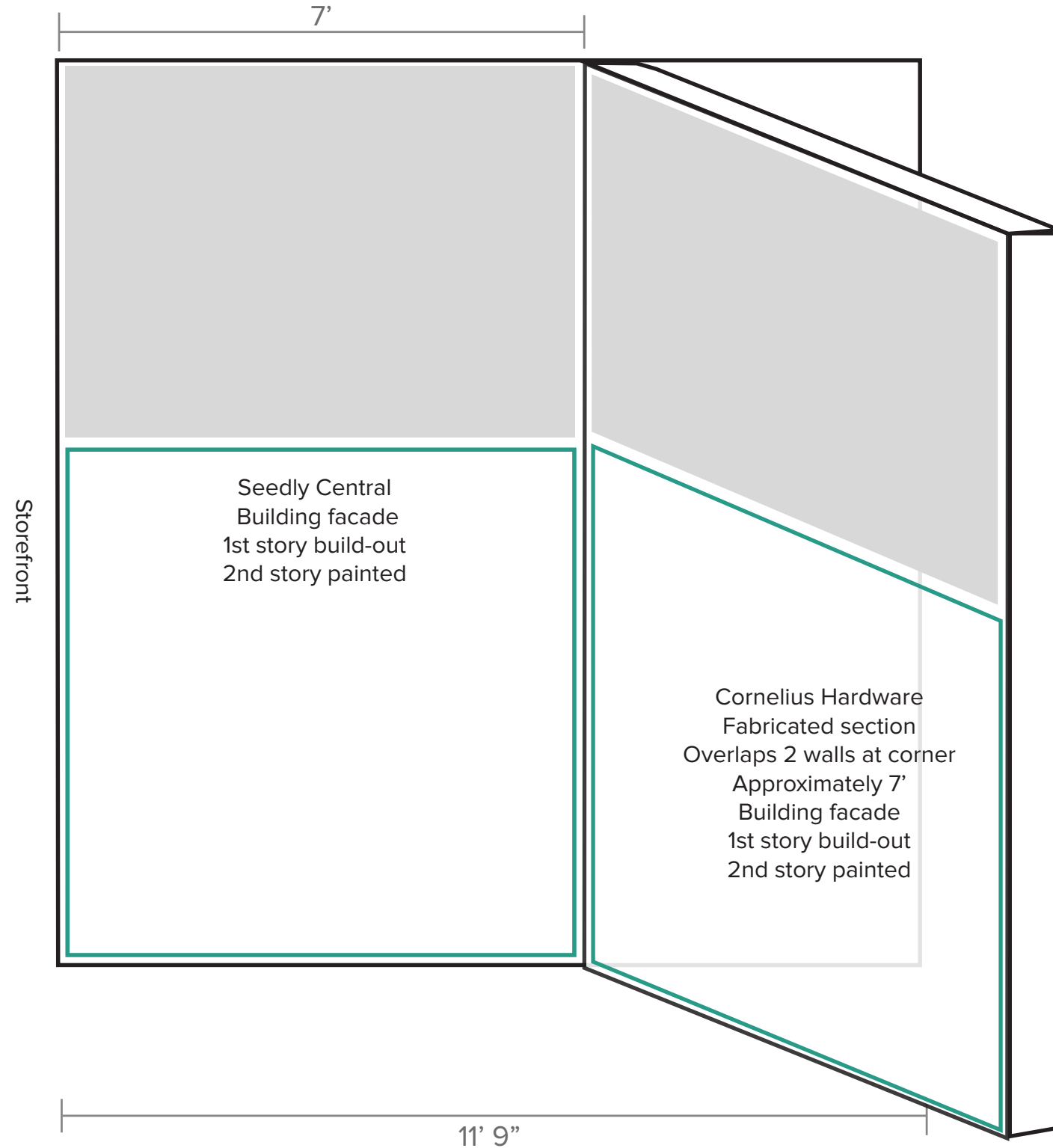

Continued next page.



1234 Main St., Green Bay, WI
920.430.7200
cineviz.com

LAYOUT & MATERIALS PLAN

Client:
Winfield Room 6

Project Number & Name:
365 - WINFI - CROP Adventure - Room 6 - From the Farm to You

Job Number & Exhibit Description:
15410 All Schematics for Room 6

Proof Date: 11-12-15

Return Date: 11-18-15

Notes:

- **Materials for 1st story fabrication (wood, drywall, etc.)**
- **1st story fabricated, second story painted.**
- **Corner section is on an angle and a wall needs to be built.**

Summary/ Experience Description

Winfield Room 5, overviews and individual pieces for fabrication.

Technology Description

Build out, fabrication and installations.

Scope of Work

Specialty Fabrication, Signage, Wall and Floor Decal, Construction, Multi-media, AV/Data, etc.

Scale: NTS

Version: 1.5

Designer: sb

Farmington Facades

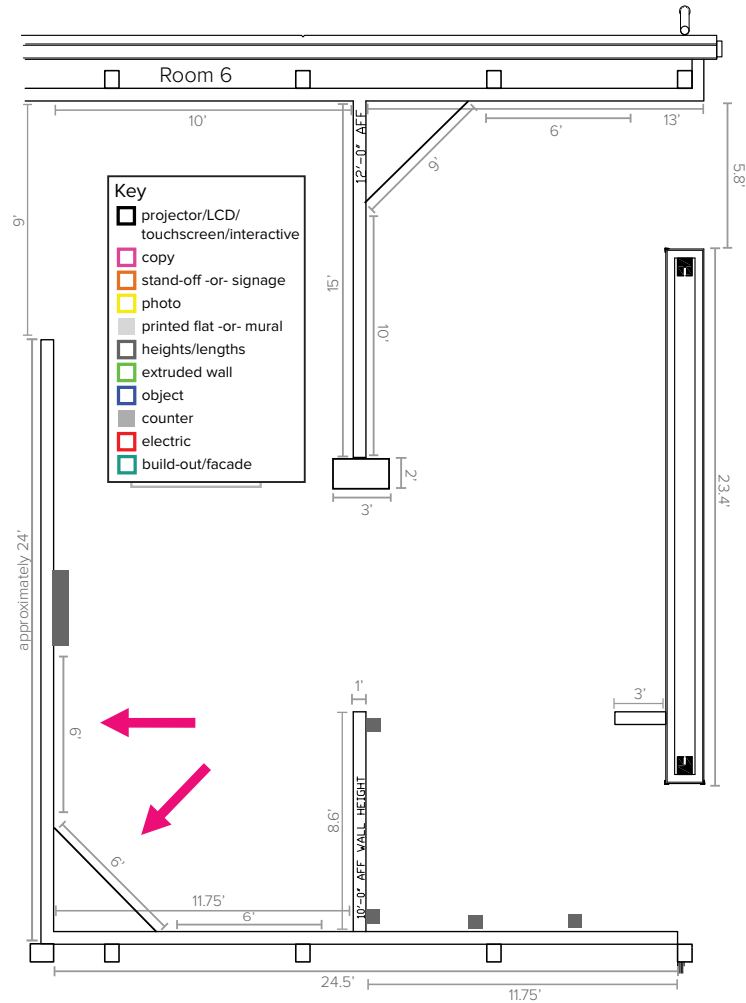

Continued from previous page.

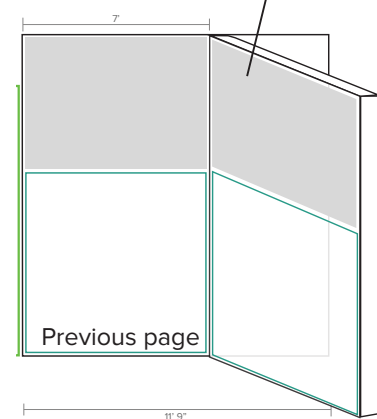
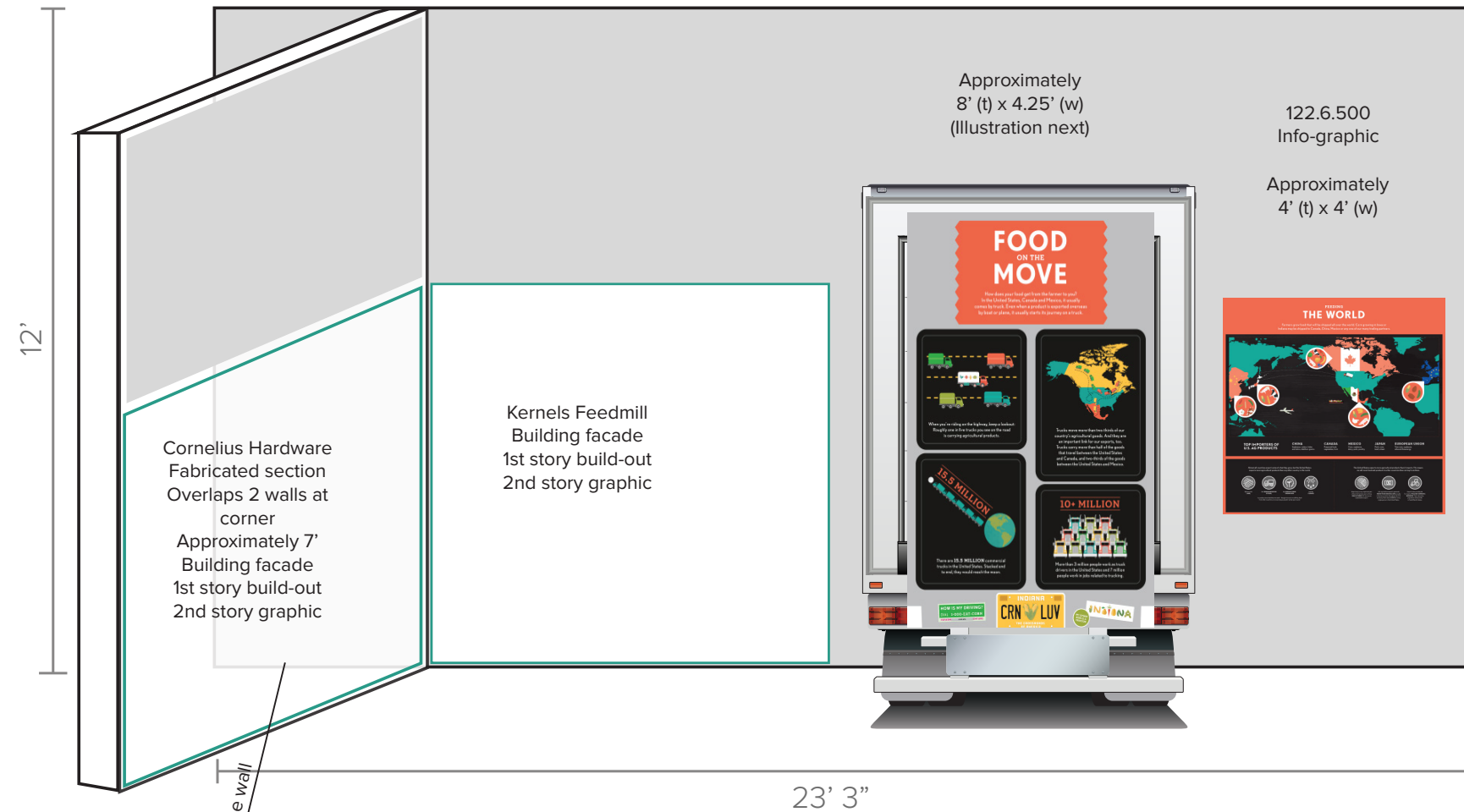

- The top silhouette--is it cut in the pattern of the building?
- Fabricated truck has signs on the back, small piece still not delivered (has FPO).
- The size of the signs on the truck may need to be changed to fit the door.



1234 Main St., Green Bay, WI
920.430.7200
cineviz.com

LAYOUT & MATERIALS PLAN

Client:
Winfield Room 6

Project Number & Name:
365 - WINFI - CROP Adventure - Room 6 - From the Farm to You

Job Number & Exhibit Description:
15410 All Schematics for Room 6

Proof Date: 11-12-15

Return Date: 11-18-15

Notes:

- Materials for fabrication for the angled wall would include anything practical (wood, dry-wall, etc.)
- 1st story fabricated, 2nd story painted.
- Truck is fabricated.
- Sign designs from CMV.

Summary/ Experience Description

Winfield Room 5, overviews and individual pieces for fabrication.

Technology Description

Build out, fabrication and installations.

Scope of Work

Specialty Fabrication, Signage, Wall and Floor Decal, Construction, Multi-media, AV/Data, etc.

Scale: NTS

Version: 1.5

Designer: sb

Farmington Facades--Semi Fabrication

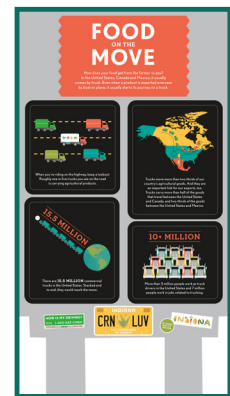
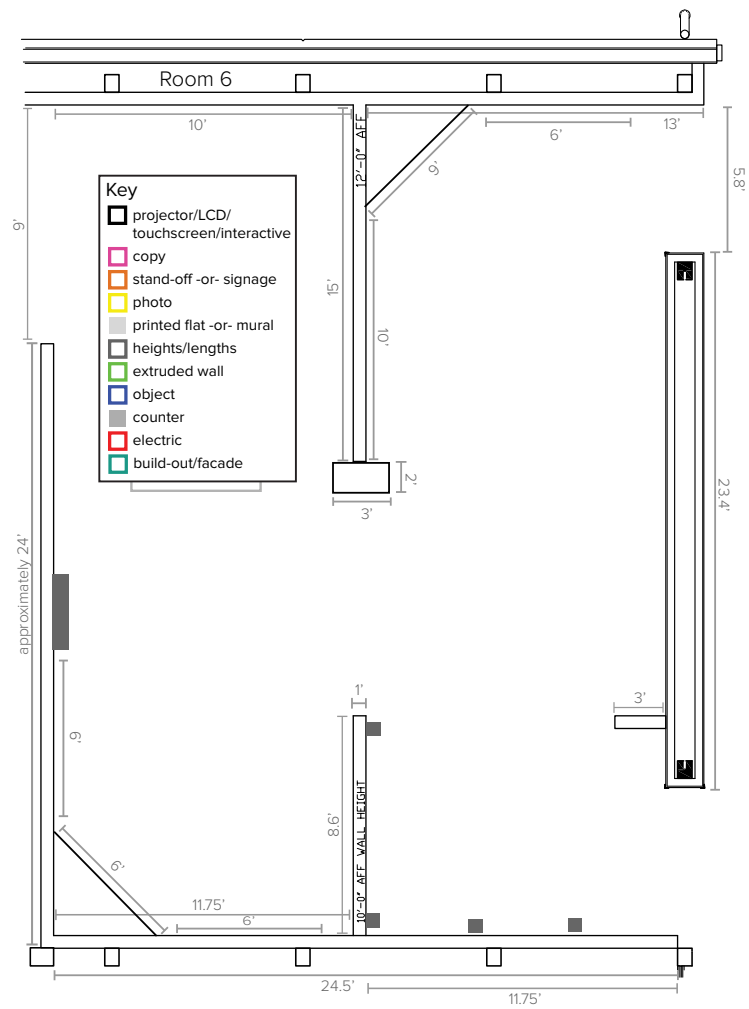

Continued from previous page.

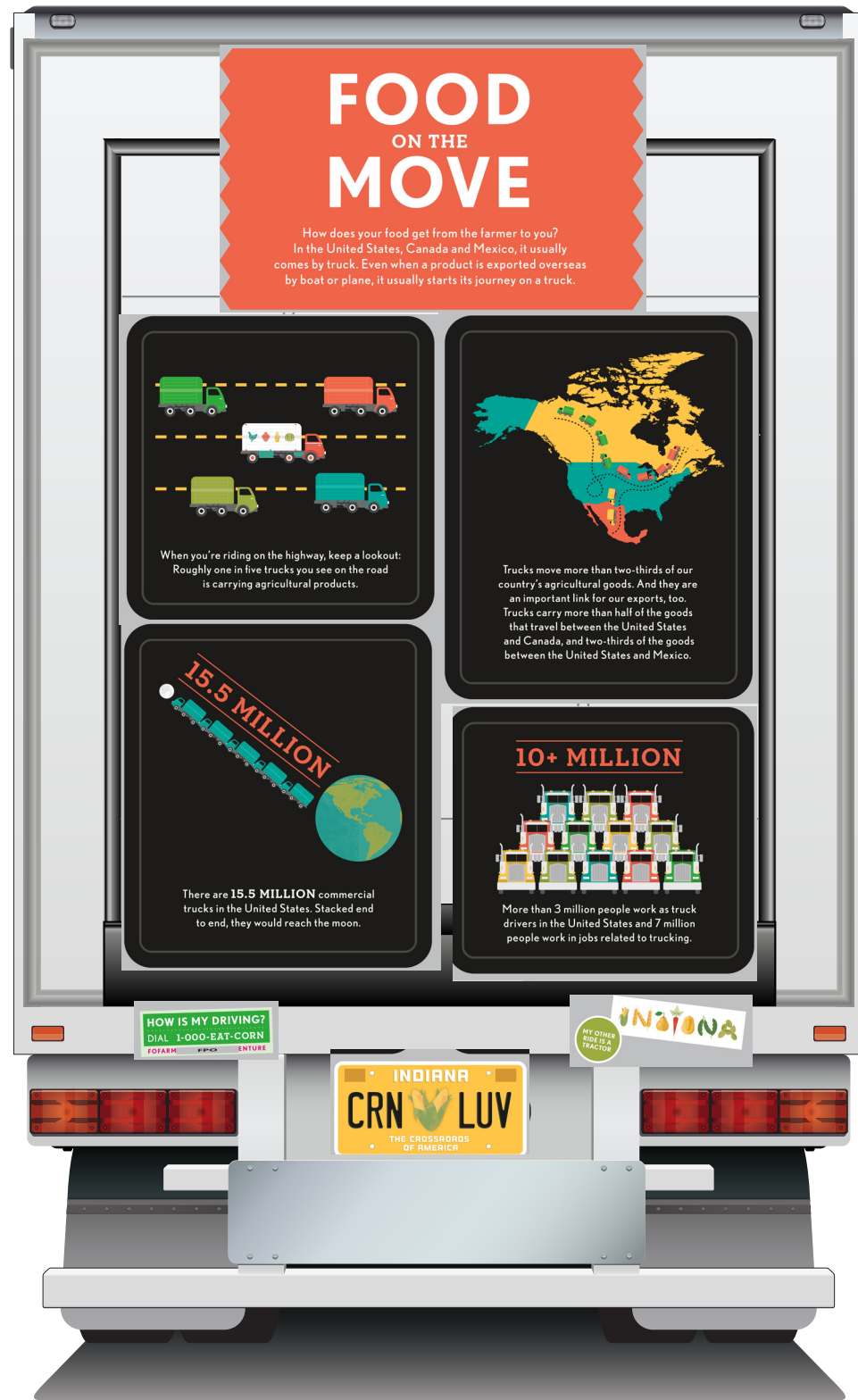

Front View:
Approximately
8' (t) x
4.25' (w)

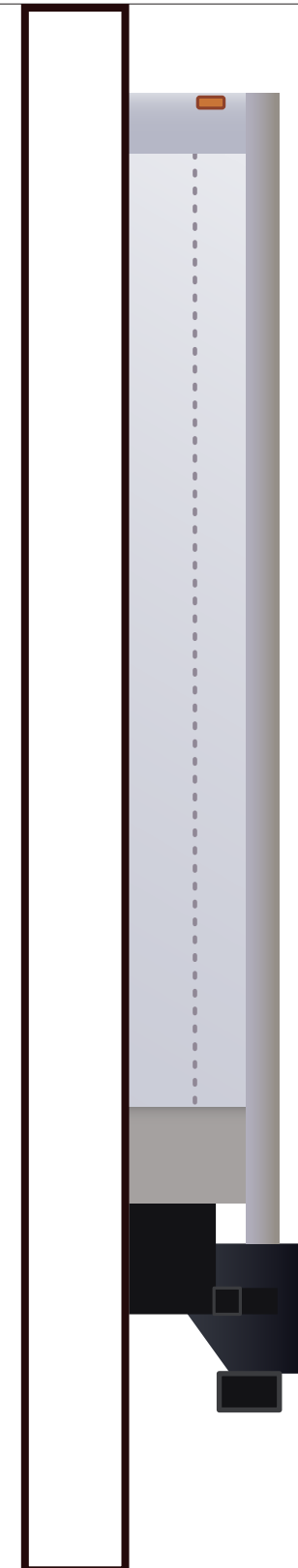

Side View:
Approximately
8' (t) x 1' (d)



1234 Main St., Green Bay, WI
920.430.7200
cineviz.com

LAYOUT & MATERIALS PLAN

Client:
Winfield Room 6

Project Number & Name:
365 - WINFI - CROP Adventure - Room 6 - From the Farm to You

Job Number & Exhibit Description:
15410 All Schematics for Room 6

Proof Date: 11-12-15

Return Date: 11-18-15

Notes:

- Fabricated grain truck with "garage" door, bumper and taillights.
- And sticks out from the wall in 3D approx. 1' deep--tire and flaps are painted or imprint.
- Sign designs from CMV.

Summary/ Experience Description

Winfield Room 5, overviews and individual pieces for fabrication.

Technology Description

Build out, fabrication and installations.

Scope of Work

Specialty Fabrication, Signage, Wall and Floor Decal, Construction, Multi-media, AV/Data, etc.

Scale: NTS

Version: 1.5

Designer: sb

Farmington Facades--Signage

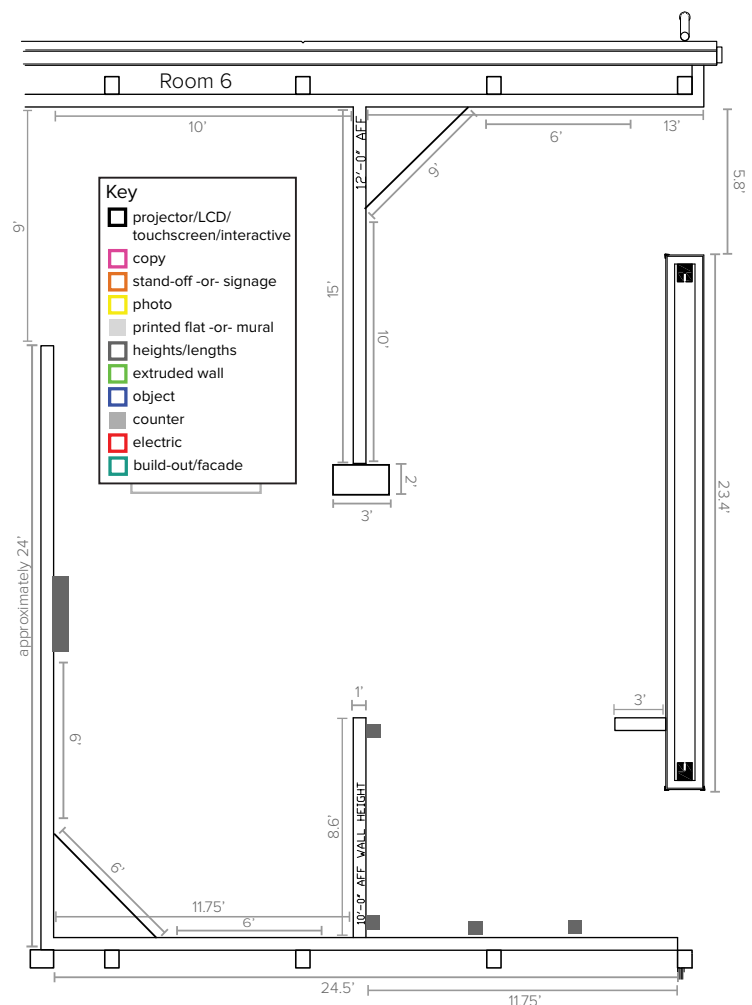

Continued from previous page.

4' x 4'

FEEDING
THE WORLD

Farmers grow food that will be shipped all over the world. Corn growing in Iowa or Indiana may be shipped to Canada, China, Mexico or any one of our many trading partners.

TOP IMPORTERS OF U.S. AG PRODUCTS

CHINA Soybeans, cotton, hides and skins, distillers grains	CANADA Prepared food, vegetables, fruit	MEXICO Corn, soybeans, dairy, pork, poultry	JAPAN Pork, corn, beef, wheat	EUROPEAN UNION Tree nuts, soybeans, ethanol/bioenergy
--	---	---	---	---

Almost all countries export some of what they grow, but the United States exports more agricultural products than any other country in the world.

We have the **LAND**.

the **TRANSPORTATION SYSTEM**.

the **AGRICULTURAL KNOW-HOW**.

and the **CLIMATE**.

to produce more food than we need — though of course we still buy food from other countries so we can enjoy a greater variety year-round.

The United States exports more agricultural products than it imports. This means we sell more food and products to other countries than we buy from them.

Exports are a very important part of how U.S. farmers earn a living. **ONE IN THREE** U.S. farm acres is planted for export.

U.S. agricultural exports generate **MORE THAN \$100 BILLION** annually in business activity throughout the U.S. economy. That's about \$300 for every single person in the United States.

Exports also provide jobs for nearly **1 MILLION DOMESTIC WORKERS**. That's about the population of Evansville or South Bend, Indiana.



1234 Main St., Green Bay, WI
920.430.7200
cineviz.com

LAYOUT & MATERIALS PLAN

Client:
Winfield Room 6

Project Number & Name:
365 - WINFI - CROP Adventure - Room 6 - From the Farm to You

Job Number & Exhibit Description:
15410 All Schematics for Room 6

Proof Date: 11-12-15

Return Date: 11-18-15

- Notes:**
- Sign designs from CMV.
 - Hangs between truck and the bend in wall.

Summary/ Experience Description
Winfield Room 5, overviews and individual pieces for fabrication.

Technology Description
Build out, fabrication and installations.

Scope of Work
Specialty Fabrication, Signage, Wall and Floor Decal, Construction, Multi-media, AV/Data, etc.

Scale: NTS
Version: 1.5
Designer: sb

Farmington Facades--Signage

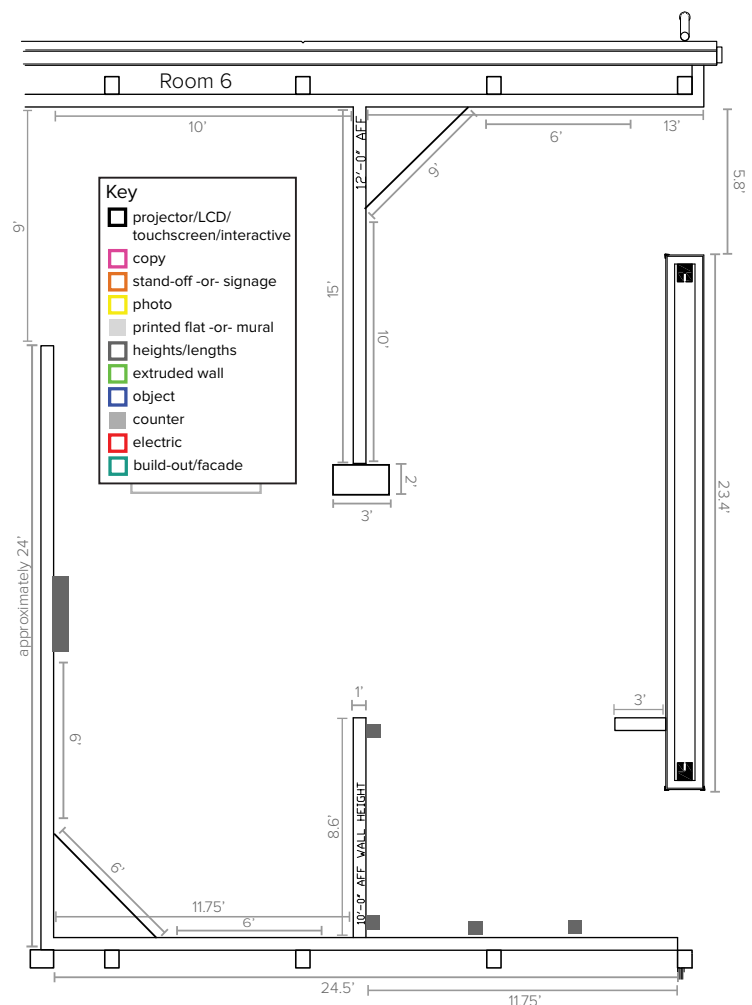

Continued from previous page.

4' x 2'

BIGGEST

AGRICULTURAL EXPORTS

America's top four agricultural exports, when you rank them by how much money they are worth, are corn, soybeans, wheat and cotton.

	● PRODUCTION	● EXPORT
 CORN	 SOYBEANS	
 WHEAT	 COTTON	

- This may be crowded on the wall



1234 Main St., Green Bay, WI
920.430.7200
cineviz.com

LAYOUT & MATERIALS PLAN

Client:
Winfield Room 6

Project Number & Name:
365 - WINFI - CROP Adventure - Room 6 - From the Farm to You

Job Number & Exhibit Description:
15410 All Schematics for Room 6

Proof Date: 11-12-15

Return Date: 11-18-15

Notes:

- Sign designs from CMV.
- Hangs after the transportation map.

Summary/ Experience Description

Winfield Room 5, overviews and individual pieces for fabrication.

Technology Description

Build out, fabrication and installations.

Scope of Work

Specialty Fabrication, Signage, Wall and Floor Decal, Construction, Multi-media, AV/Data, etc.

Scale: NTS

Version: 1.5

Designer: sb

Factory Processing Wall

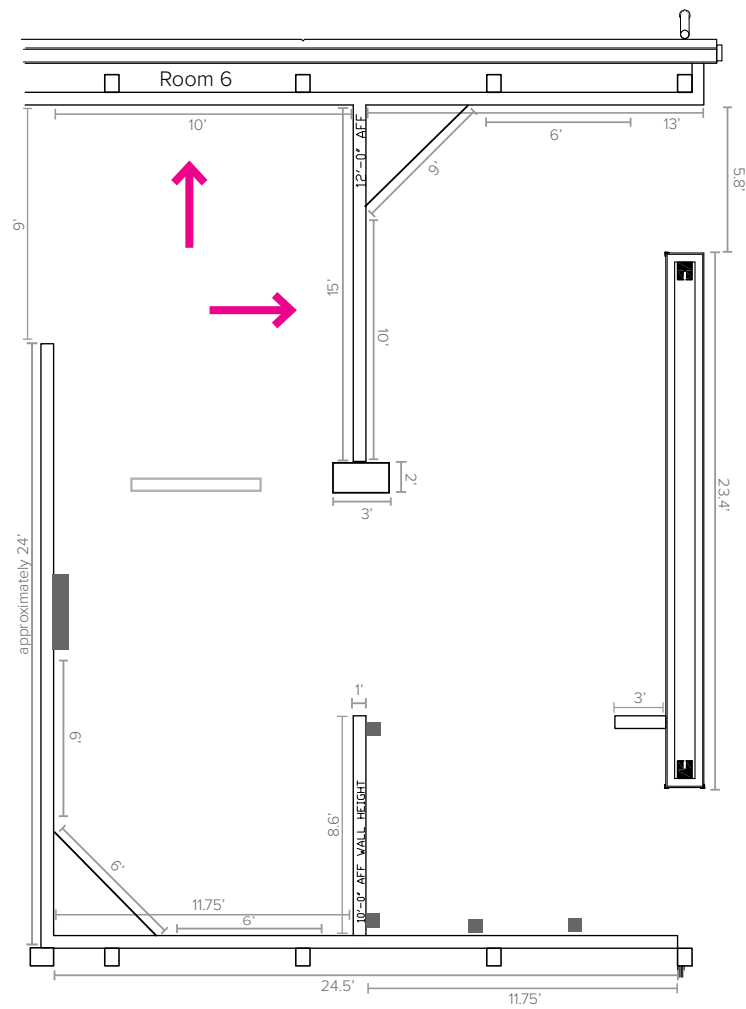

- Fabricated--pipes are attached to the wall within the imprints
- Need to mock-up the shelf and canisters?

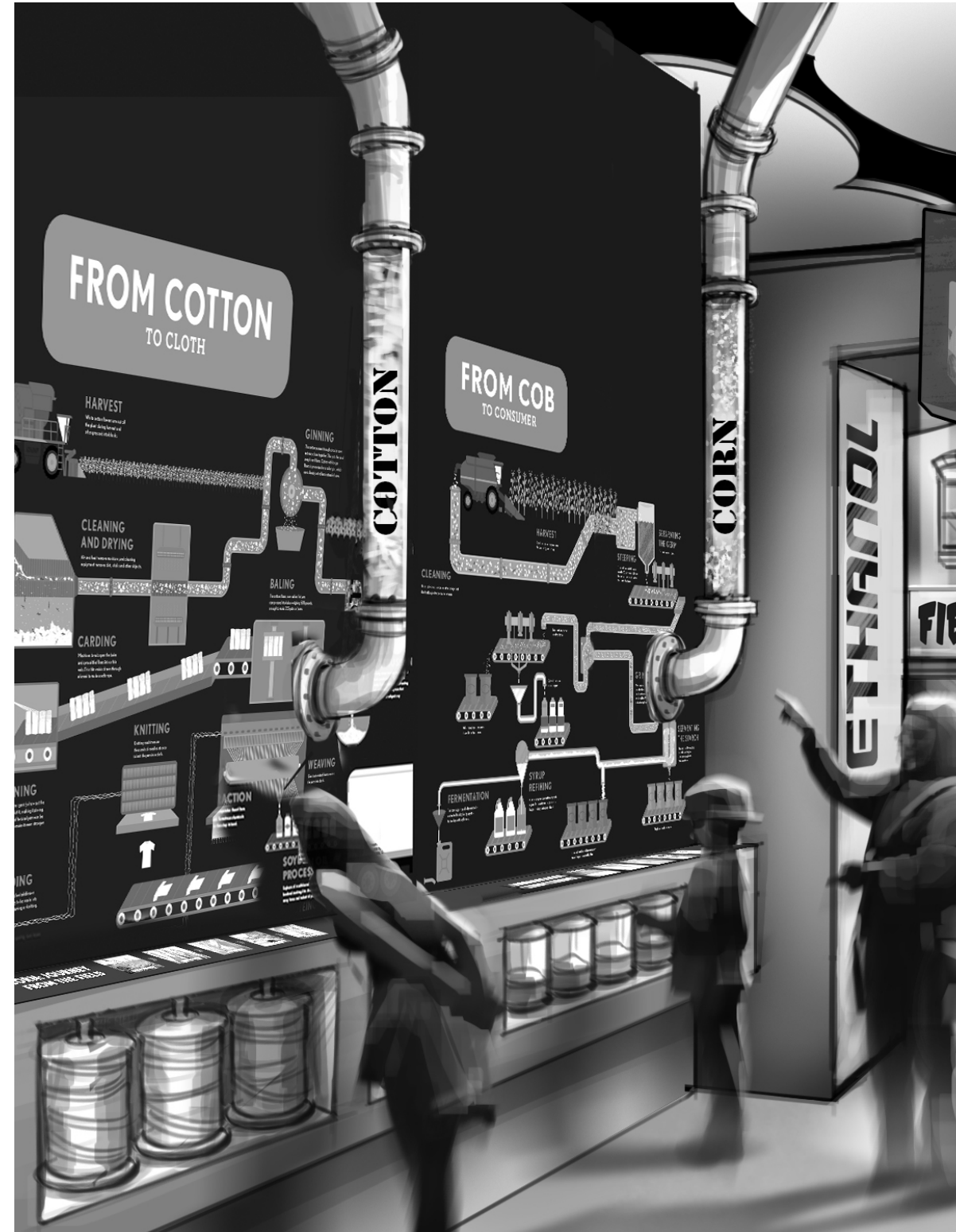

1234 Main St., Green Bay, WI
920.430.7200
cineviz.com

LAYOUT & MATERIALS PLAN

Client:
Winfield Room 6

Project Number & Name:
365 - WINFI - CROP Adventure - Room 6 - From the Farm to You

Job Number & Exhibit Description:
15410 All Schematics for Room 6

Proof Date: 11-12-15

Return Date: 11-18-15

Notes:

- Materials for pipe
- Fabrication would include anything practical these need a clear acrylic section that shows the type of seed/ grain that is represented (wood, drywall, fiberglass or metal.)
- Shelf has imprint on the top surface and canisters set in the face.
- Tubes go across the ceiling to another exhibit.

Summary/ Experience Description

Winfield Room 5, overviews and individual pieces for fabrication.

Technology Description

Build out, fabrication and installations.

Scope of Work

Specialty Fabrication, Signage, Wall and Floor Decal, Construction, Multi-media, AV/Data, etc.

Scale: NTS

Version: 1.5

Designer: sb

Factory Processing Wall

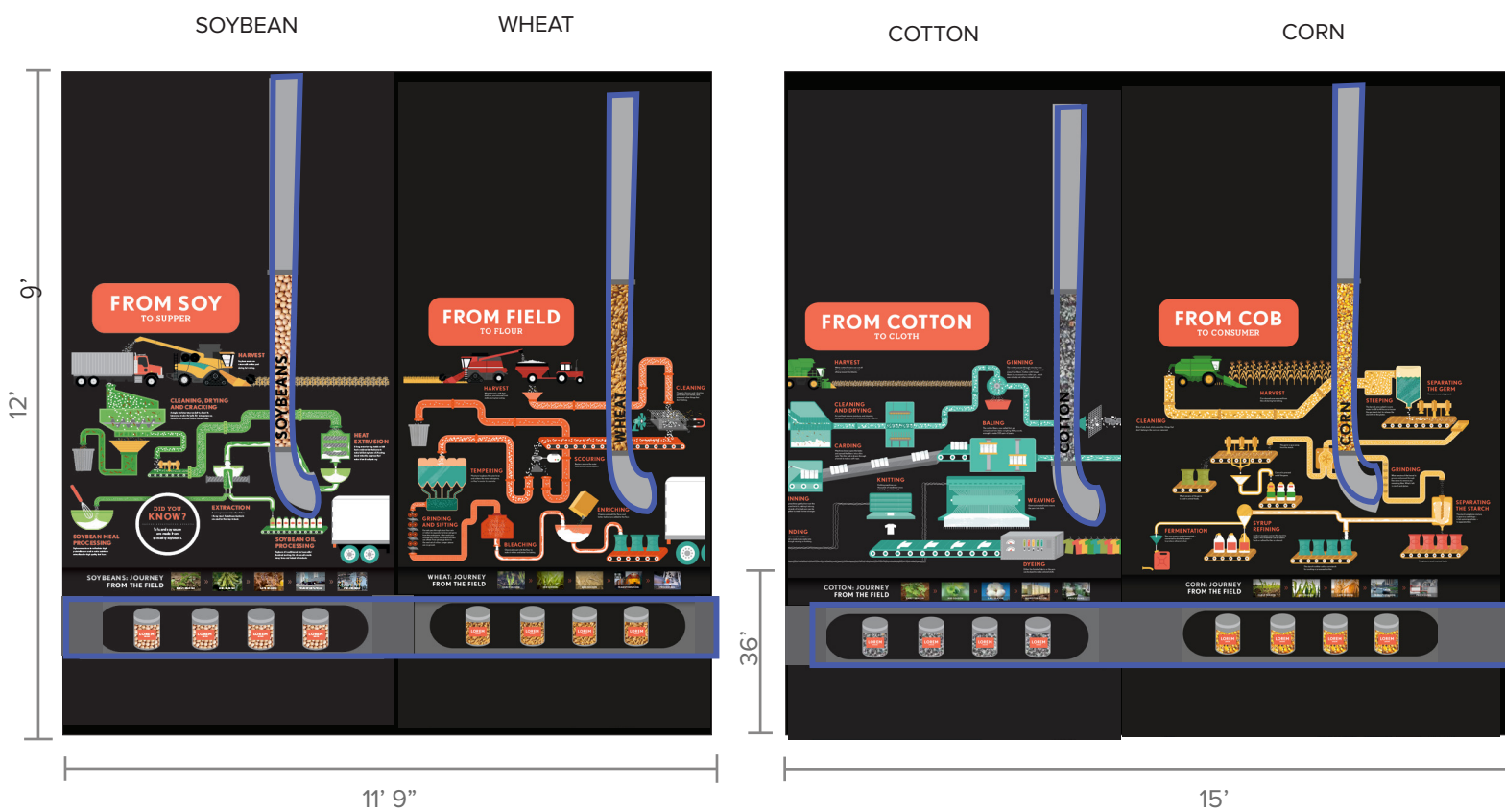
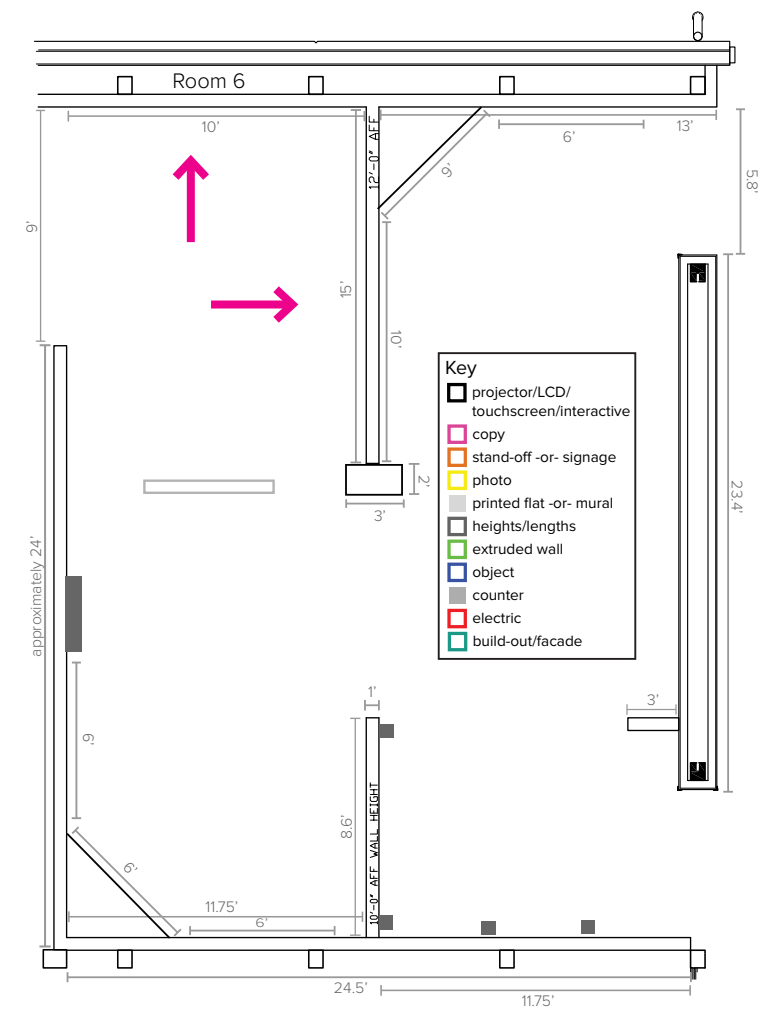

“Free-standing” Gas pump is at the end of this wall - Approximately 1’ (w) x 4’ (d) x ~9’ (h) with 22” monitor

- Tubes have imprint on them, need graphics



Summary/ Experience Description
Winfield Room 5, overviews and individual pieces for fabrication.

Technology Description
Build out, fabrication and installations.

Scope of Work
Specialty Fabrication, Signage, Wall and Floor Decal, Construction, Multi-media, AV/Data, etc.

LAYOUT & MATERIALS PLAN

Client:
Winfield Room 6

Project Number & Name:
365 - WINFI - CROP Adventure - Room 6 - From the Farm to You

Job Number & Exhibit Description:
15410 All Schematics for Room 6

Proof Date: 11-12-15

Return Date: 11-18-15

- Notes:**
- Wall Imprint and sign designs from CMV.
 - The bottom of the wall has shelves that house canisters, these will be relevant to the imprint above.
 - The gas pump is immediately following this section of wall.
 - Tubes flow across ceiling to grain bin.
 - Rail continues around wall, including one corner.

Scale: NTS
Version: 1.5
Designer: sb

Gas Pump

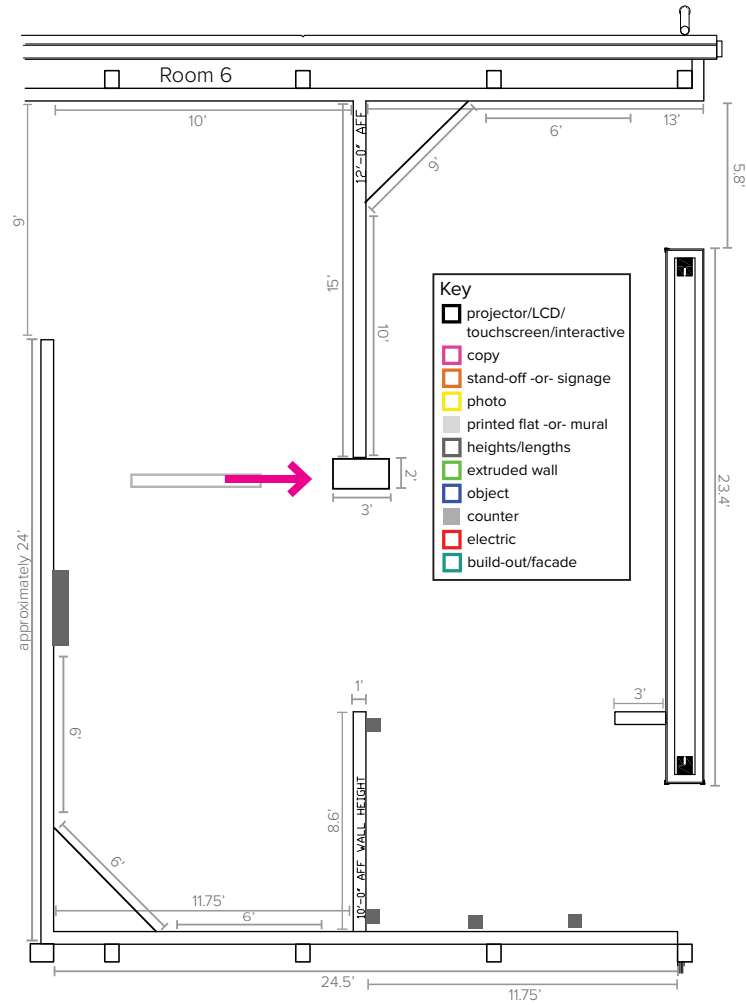

LAYOUT & MATERIALS PLAN

Client:
Winfield Room 6

Project Number & Name:
365 - WINFI - CROP Adventure - Room 6 - From the Farm to You

Job Number & Exhibit Description:
15410 All Schematics for Room 6

Proof Date: 11-12-15

Return Date: 11-18-15

Notes:

- Fabricated gas pump with monitor.
- Monitor is triggered by cards and an NFC reader.
- The monitor will have motion graphics relevant to the methods of shipping.
- Approximately 9' tall. 1'x3'.

Summary/ Experience Description

Winfield Room 5, overviews and individual pieces for fabrication.

Technology Description

Build out, fabrication and installations.

Scope of Work

Specialty Fabrication, Signage, Wall and Floor Decal, Construction, Multi-media, AV/Data, etc.

Scale: NTS

Version: 1.5

Designer: sb

Factory Processing Wall

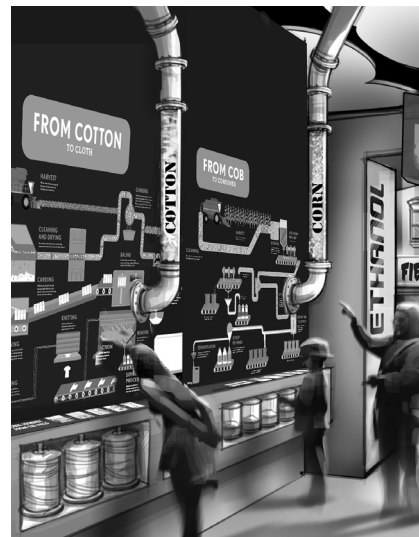
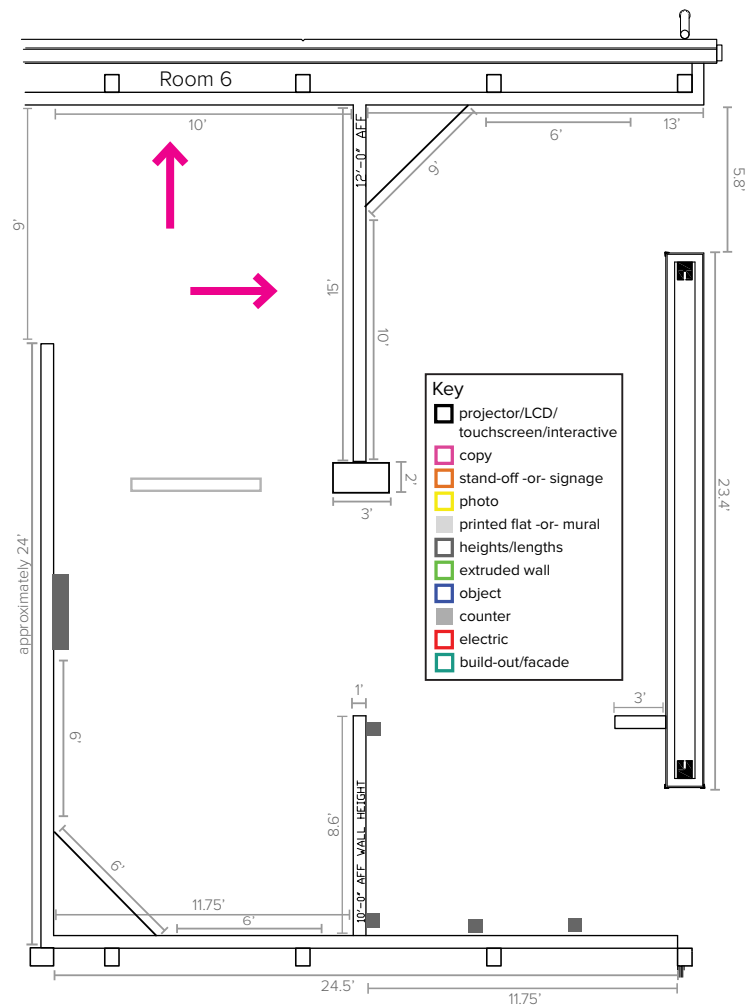

Continued from previous page.

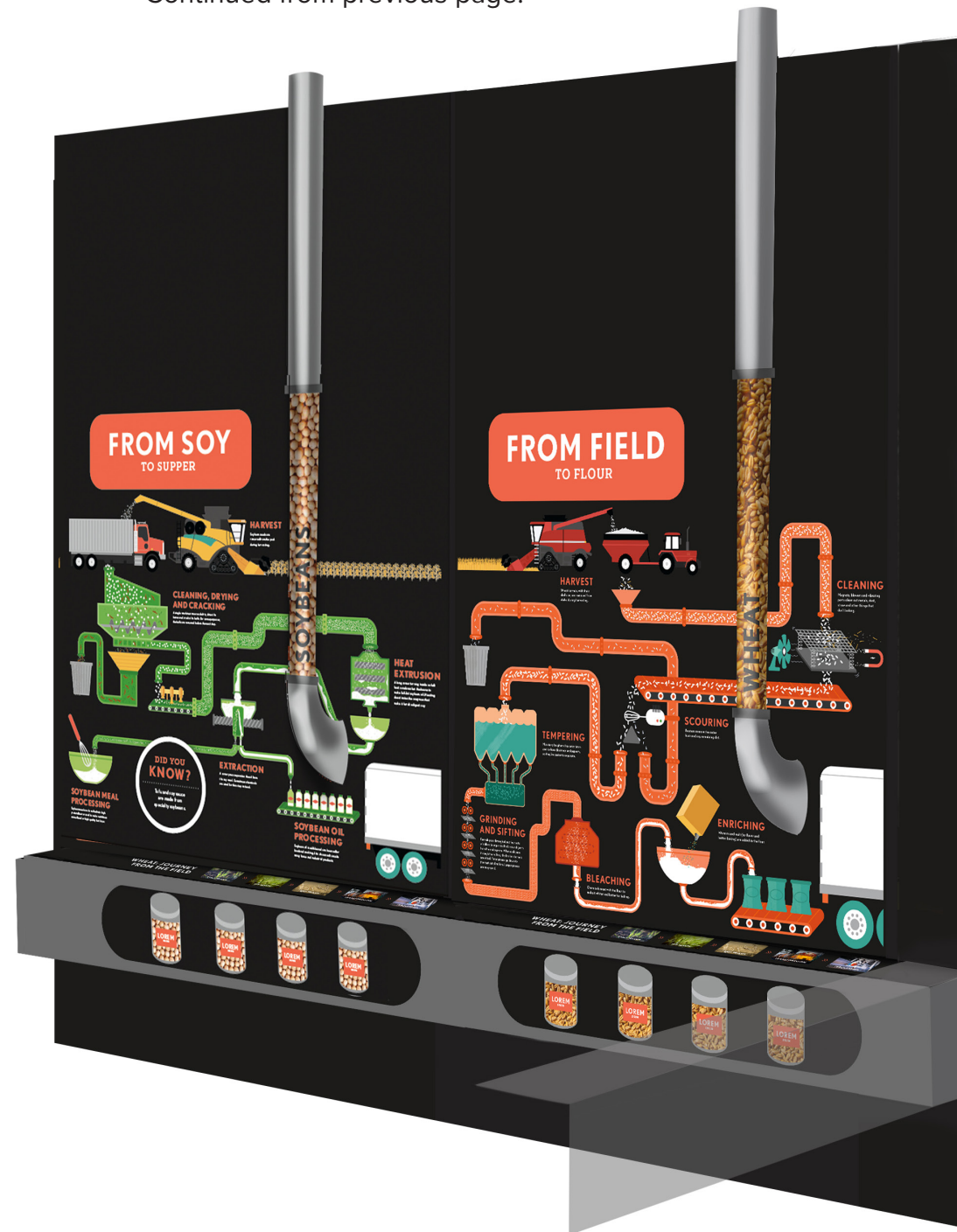

- The labels for the canisters need to be created
- Need the radius or diameter for the end of the pipes



1234 Main St., Green Bay, WI
920.430.7200
cineviz.com

LAYOUT & MATERIALS PLAN

Client:
Winfield Room 6

Project Number & Name:
365 - WINFI - CROP Adventure - Room 6 - From the Farm to You

Job Number & Exhibit Description:
15410 All Schematics for Room 6

Proof Date: 11-12-15

Return Date: 11-18-15

Notes:

- Fabricated pipes must link to the wall in the appropriate place and run across the ceiling to another exhibit.
- The graphics must fit on the wall with a rail below, also having a graphic.
- The face of the rail has an opening that contains coordinating materials.

Summary/ Experience Description

Winfield Room 5, overviews and individual pieces for fabrication.

Technology Description

Build out, fabrication and installations.

Scope of Work

Specialty Fabrication, Signage, Wall and Floor Decal, Construction, Multi-media, AV/Data, etc.

Scale: NTS

Version: 1.5

Designer: sb

Factory Processing Wall

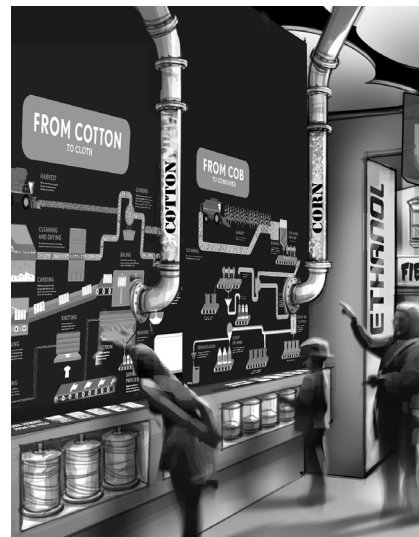
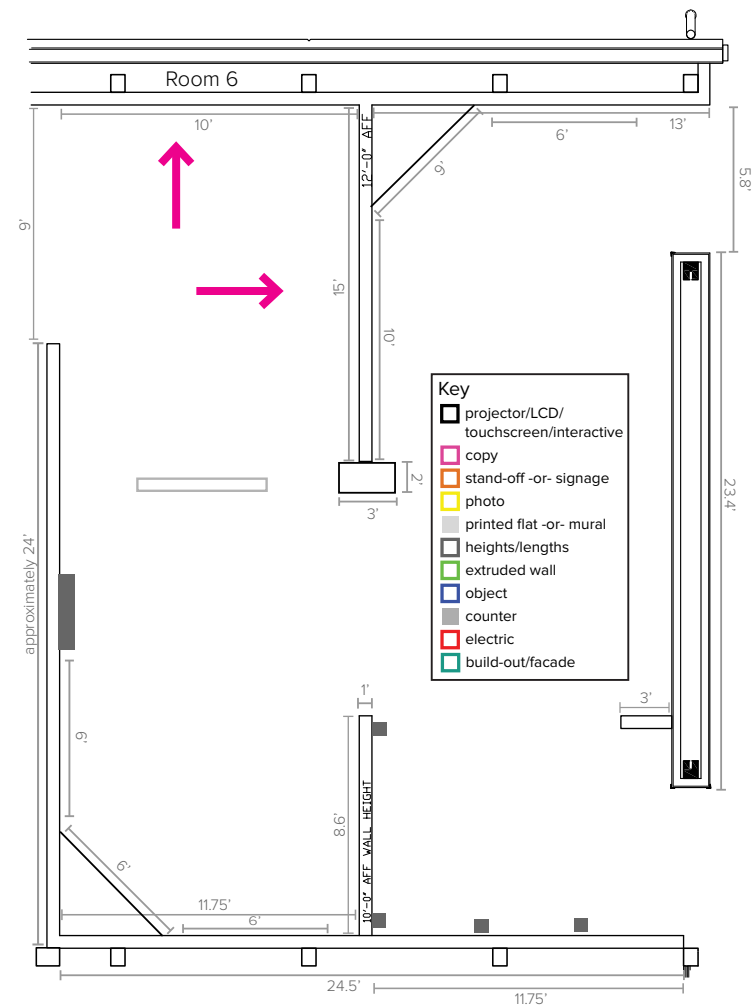

Continued from previous page.

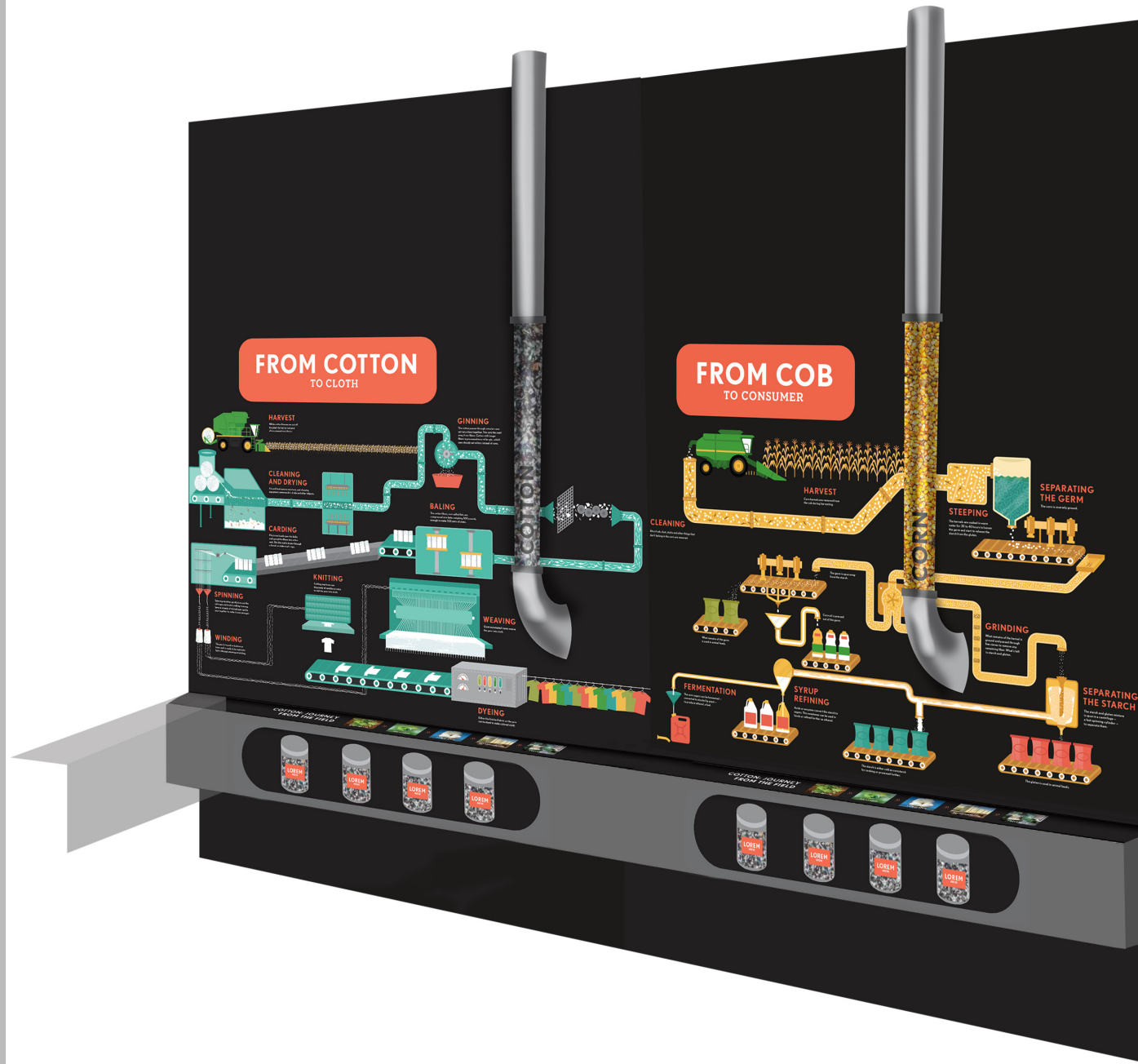

- The labels for the canisters need to be created
- Need the radius or diameter for the end of the pipes



1234 Main St., Green Bay, WI
920.430.7200
cineviz.com

LAYOUT & MATERIALS PLAN

Client:
Winfield Room 6

Project Number & Name:
365 - WINFI - CROP Adventure - Room 6 - From the Farm to You

Job Number & Exhibit Description:
15410 All Schematics for Room 6

Proof Date: 11-12-15

Return Date: 11-18-15

Notes:

- Fabricated pipes must link to the wall in the appropriate place and run across the ceiling to another exhibit.
- The graphics must fit on the wall with a rail below, also having a graphic.
- The face of the rail has an opening that contains coordinating materials.

Summary/ Experience Description

Winfield Room 5, overviews and individual pieces for fabrication.

Technology Description

Build out, fabrication and installations.

Scope of Work

Specialty Fabrication, Signage, Wall and Floor Decal, Construction, Multi-media, AV/Data, etc.

Scale: NTS

Version: 1.5

Designer: sb

Gas Pump

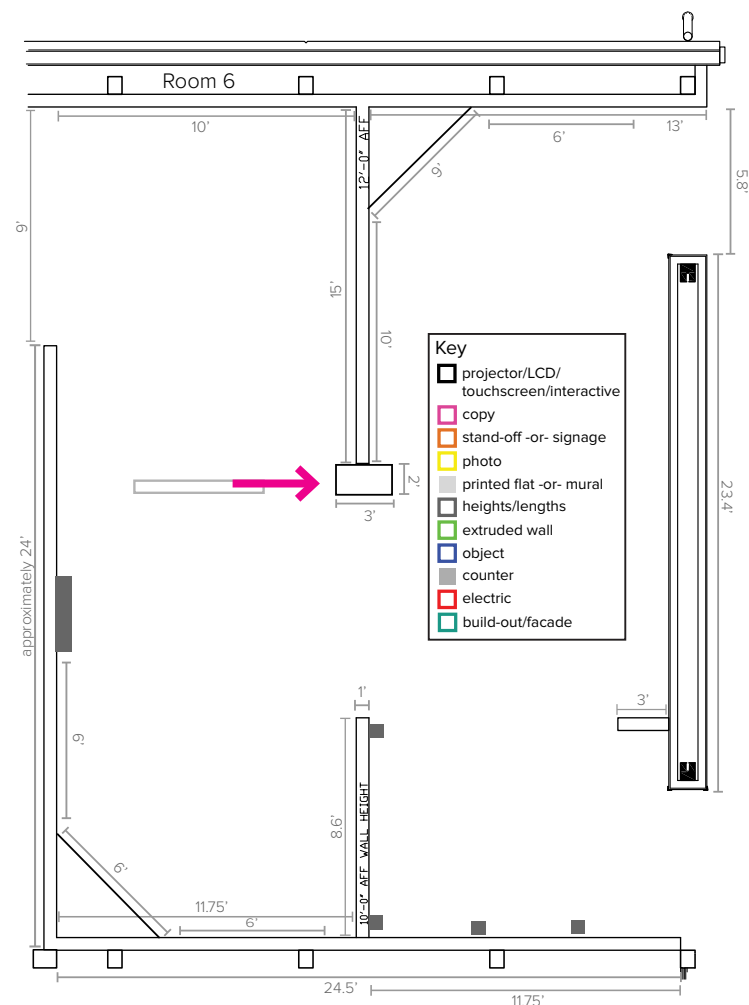

- Gas pump needs three cards with NFC reader that trigger different animations
- Need graphics for the gas pump



1234 Main St., Green Bay, WI
920.430.7200
cineviz.com

LAYOUT & MATERIALS PLAN

Client:
Winfield Room 6

Project Number & Name:
365 - WINFI - CROP Adventure - Room 6 - From the Farm to You

Job Number & Exhibit Description:
15410 All Schematics for Room 6

Proof Date: 11-12-15

Return Date: 11-18-15

Notes:

- Fabricated gas pump with monitor.
- Monitor is triggered by cards and an NFC reader.
- The motion graphics are relevant to the methods of shipping.
- Approximately 9' tall. 1' wide x 3' across the face .
- Graphic sign will hang near or on the pump.
- Like illustration, there are lights in the header.

Summary/ Experience Description

Winfield Room 5, overviews and individual pieces for fabrication.

Technology Description

Build out, fabrication and installations.

Scope of Work

Specialty Fabrication, Signage, Wall and Floor Decal, Construction, Multi-media, AV/Data, etc.

Scale: NTS

Version: 1.5

Designer: sb

Career and Farm it Forward Wall

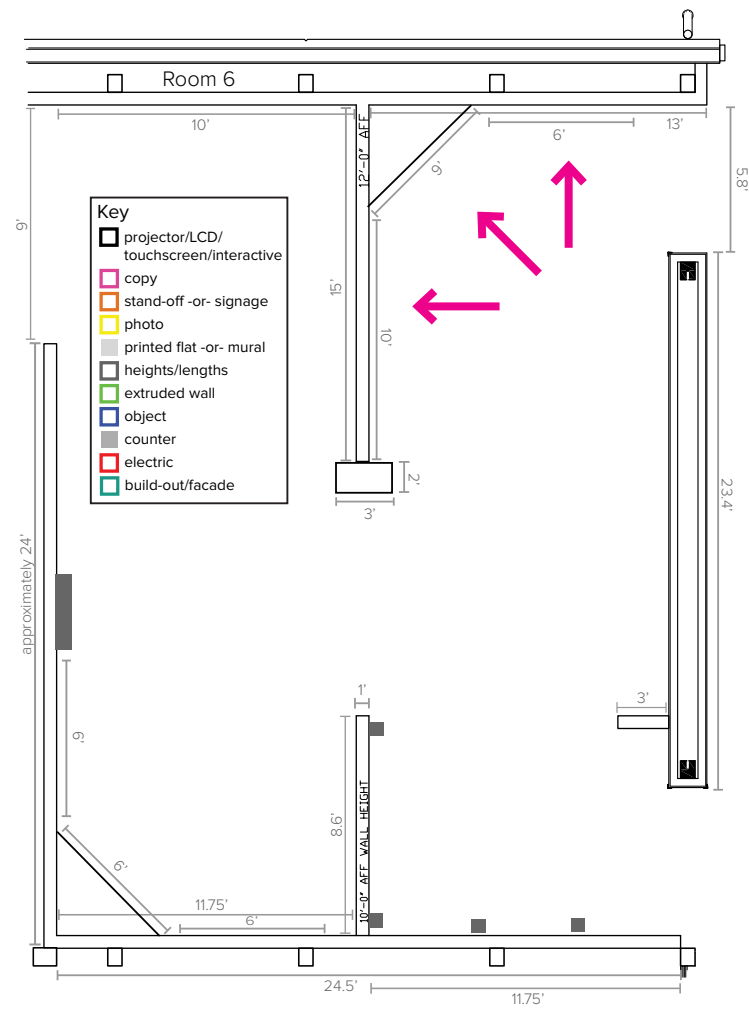

- Who determines/gets the clothes for the closet
- The fabricated signs above--where is the art coming from?
- Store signs need to be created or delivered, if not, painted?



1234 Main St., Green Bay, WI
920.430.7200
cineviz.com

LAYOUT & MATERIALS PLAN

Client:
Winfield Room 6

Project Number & Name:
365 - WINFI - CROP Adventure - Room 6 - From the Farm to You

Job Number & Exhibit Description:
15410 All Schematics for Room 6

Proof Date: 11-12-15

Return Date: 11-18-15

Notes:

- 3 fabricated facades: Career quiz, clothes closet, photo op, and farm it forward.
- 1st story is fabricated, 2nd story is a mural.
- Sign designs delivered from CMV.
- Tablets are mounted to the wall.
- Photo Op is on a slanted wall that will need to be built across the corner.

Summary/ Experience Description

Winfield Room 5, overviews and individual pieces for fabrication.

Technology Description

Build out, fabrication and installations.

Scope of Work

Specialty Fabrication, Signage, Wall and Floor Decal, Construction, Multi-media, AV/Data, etc.

Scale: NTS

Version: 1.5

Designer: sb

Career and Farm it Forward Wall

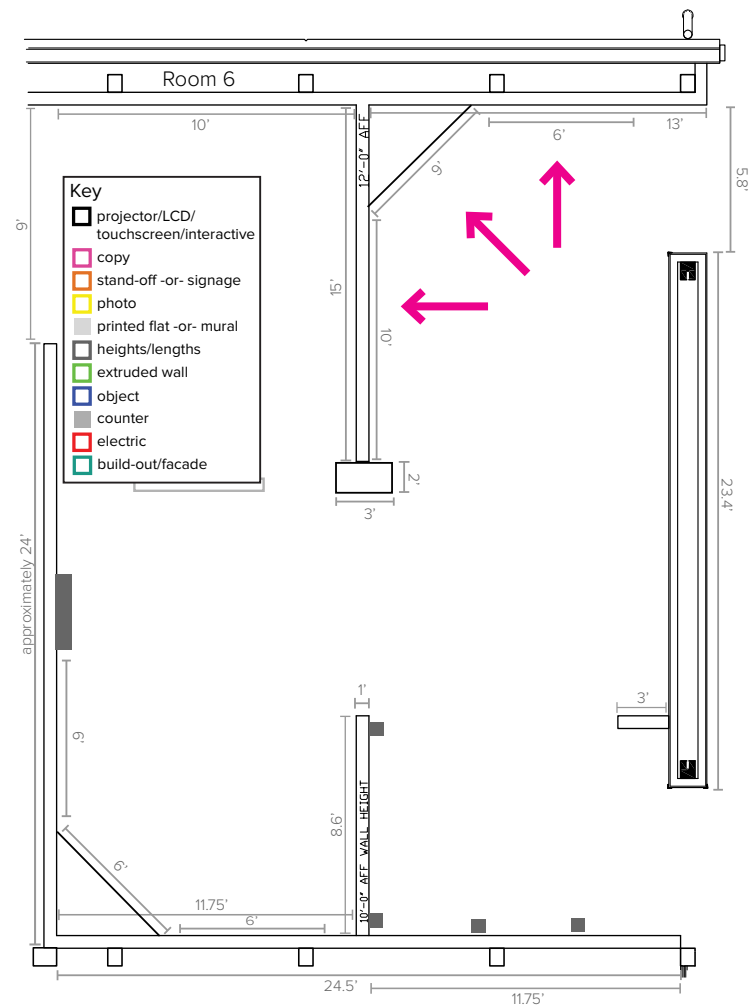

"Free-standing" gas pump is at the beginning of this wall - approximately 1' (w) x 4' (d) x ~9' (h) with 22" monitor

- Clothes--where are they coming from?



LAYOUT & MATERIALS PLAN

Client:
Winfield Room 6

Project Number & Name:
365 - WINFI - CROP Adventure - Room 6 - From the Farm to You

Job Number & Exhibit Description:
15410 All Schematics for Room 6

Proof Date: 11-12-15

Return Date: 11-18-15

Notes:

- 3 fabricated facades: Career quiz, clothes closet, photo op, and farm it forward.
- 1st story is fabricated, 2nd story is a mural.
- Sign designs delivered from CMV.
- Tablets are mounted to the wall.
- Photo op is on a slanted wall that will need to be built across the corner.

Summary/ Experience Description

Winfield Room 5, overviews and individual pieces for fabrication.

Technology Description

Build out, fabrication and installations.

Scope of Work

Specialty Fabrication, Signage, Wall and Floor Decal, Construction, Multi-media, AV/Data, etc.

Scale: NTS

Version: 1.5

Designer: sb

Career and Farm it Forward Wall

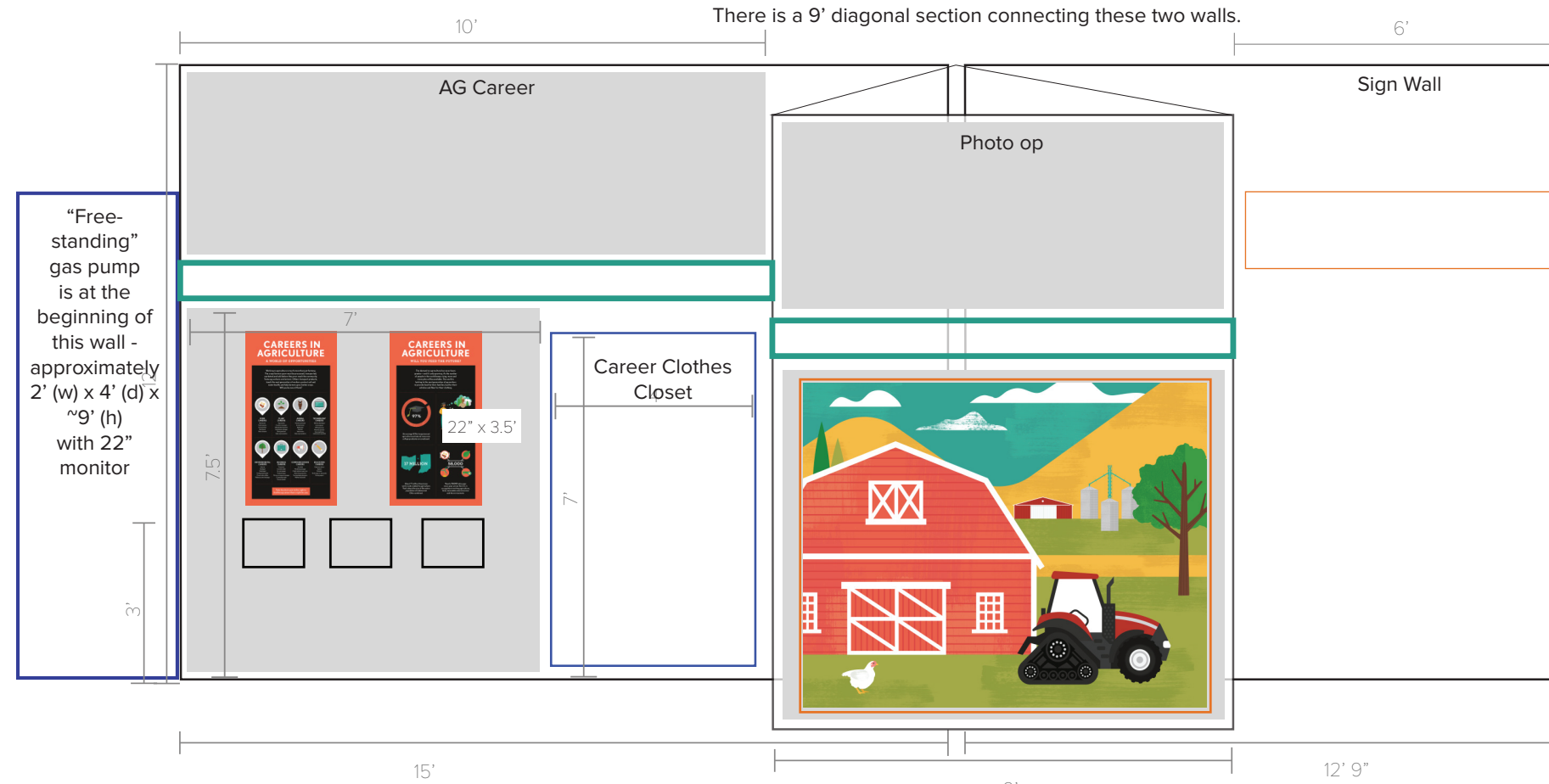
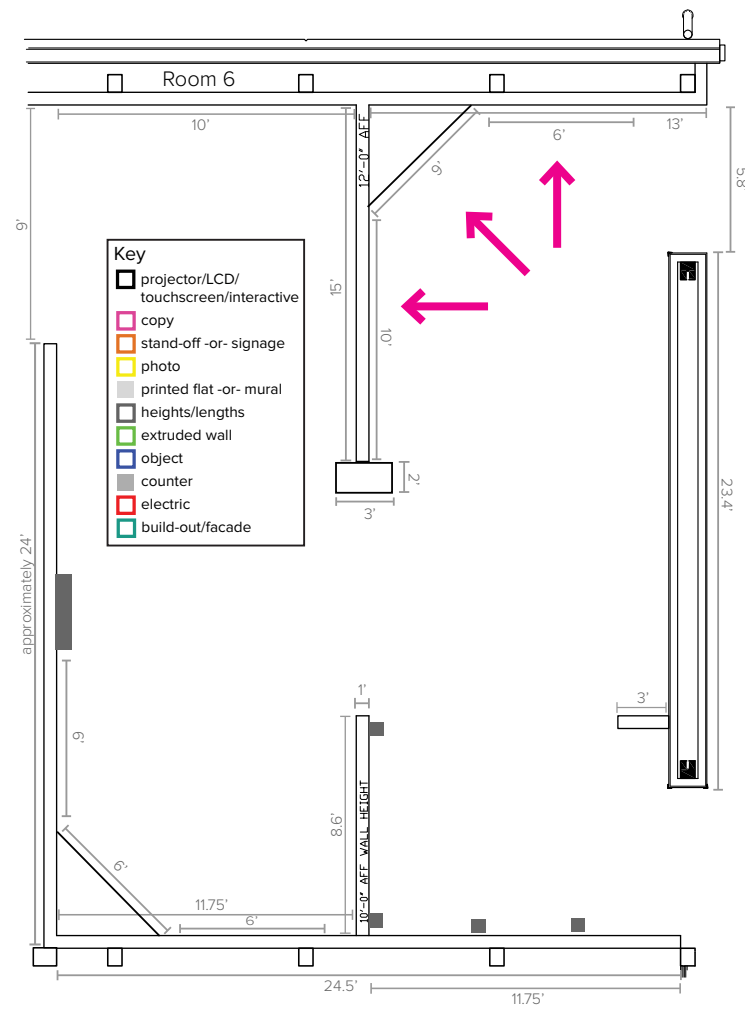

1234 Main St., Green Bay, WI
920.430.7200
cineviz.com

LAYOUT & MATERIALS PLAN

Client:
Winfield Room 6

Project Number & Name:
365 - WINFI - CROP Adventure - Room 6 - From the Farm to You

Job Number & Exhibit Description:
15410 All Schematics for Room 6

Proof Date: 11-12-15

Return Date: 11-18-15

Notes:

- 3 fabricated facades: Career quiz, clothes closet, photo op, and farm it forward tweet wall.
- 1st story is fabricated, 2nd story is a mural
- Sign wall is gray with fabricated sign
- Sign designs delivered from CMV.
- Tablets are mounted to the wall.
- Photo op is on a slanted wall that will need to be built across the corner.

Summary/ Experience Description

Winfield Room 5, overviews and individual pieces for fabrication.

Technology Description

Build out, fabrication and installations.

Scope of Work

Specialty Fabrication, Signage, Wall and Floor Decal, Construction, Multi-media, AV/Data, etc.

Scale: NTS

Version: 1.5

Designer: sb

Career and Farm it Forward Wall

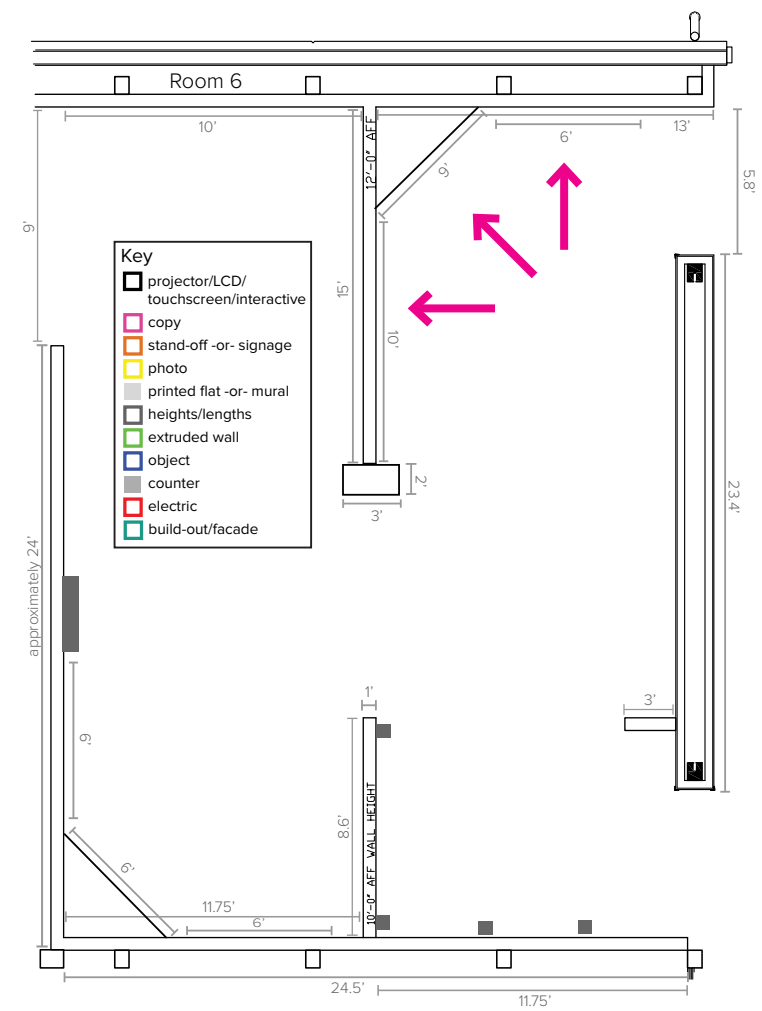

Summary/ Experience Description
Winfield Room 5, overviews and individual pieces for fabrication.

22" x 3.5'

CAREERS IN AGRICULTURE

A WORLD OF OPPORTUNITIES

Working in agriculture is much more than just farming. The crops farmers grow must be processed, transported, marketed and sold before they ever reach the community. Some ag workers are farmers. Others transport products, teach the next generation of workers, protect soil and water health, and help farmers grow better crops. Will you be one of them?

<p>FOOD CAREERS Biochemist Food inspector Food scientist Nutritionist Flavor chemist</p>	<p>PLANT CAREERS Agronomist Crop farm manager Ethanol plant operator Greenhouse manager Plant geneticist Sales representative</p>	<p>ANIMAL CAREERS Animal nutritionist Animal trainer Beekeeper Rancher Veterinarian Sales representative</p>	<p>TECHNOLOGY CAREERS Software developer Civil engineer GPS technician Machine operator Farm machinery maintenance specialist</p>
<p>ENVIRONMENTAL CAREERS Arborist Geologist Hydrologist Ecology team leader Conservation officer Pollution control manager</p>	<p>BUSINESS CAREERS Economist Livestock seller Co-op manager Products buyer Driver or transport manager Commodity trader Finance banker</p>	<p>COMMUNICATIONS CAREERS Journalist Marketing manager Public relations supervisor Advertising executive Food packaging designer Market researcher</p>	<p>EDUCATION CAREERS Extension advisor Teacher Professor Park ranger or interpreter Training expert</p>

Take the short quiz to the right to find the ag career that is right for you.

Technology Description
Build out, fabrication and installations.

CAREERS IN AGRICULTURE

WILL YOU FEED THE FUTURE?

The demand on agriculture has never been greater—and it's only growing. As the number of people in the world keeps rising, more and more jobs will be available. The world is looking to the next generation of ag workers to provide food for their families, fuel for their vehicles and fiber for their clothing.

On average 97% of experienced agriculture and natural resources college graduates are employed.

There are twice as many agriculture job openings as graduates.

About 17 million Americans work in jobs related to agriculture. That's about the size of the entire population of Indiana and Ohio combined.

Nearly 58,000 jobs open every year across the U.S. in occupations involving agriculture, food, renewable natural sources and the environment.

Scope of Work
Specialty Fabrication, Signage, Wall and Floor Decal, Construction, Multi-media, AV/Data, etc.

LAYOUT & MATERIALS PLAN

Client:
Winfield Room 6

Project Number & Name:
365 - WINFI - CROP Adventure - Room 6 - From the Farm to You

Job Number & Exhibit Description:
15410 All Schematics for Room 6

Proof Date: 11-12-15

Return Date: 11-18-15

- Notes:**
- Sign designs delivered from CMV.
 - Signs should be in the windows of the career center. Windows must be larger than 22" wide.

Scale: NTS
Version: 1.5
Designer: sb

Cornville hanging sign

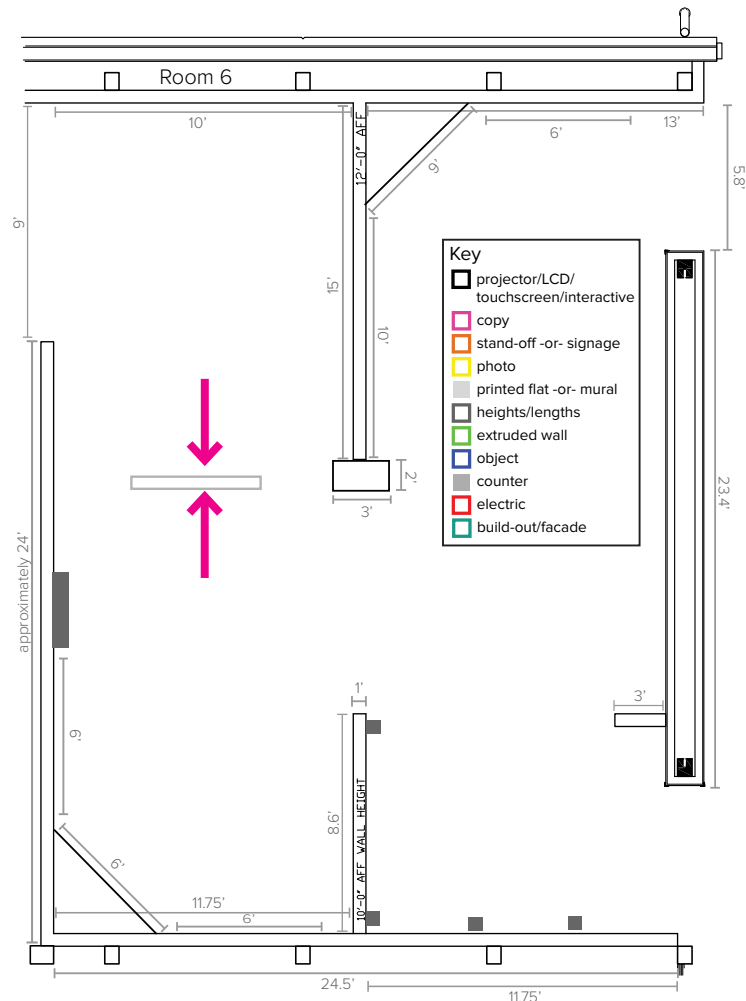

“Cornville” hanging sign--2 sided
(Actual name and content to be determined by C+M)

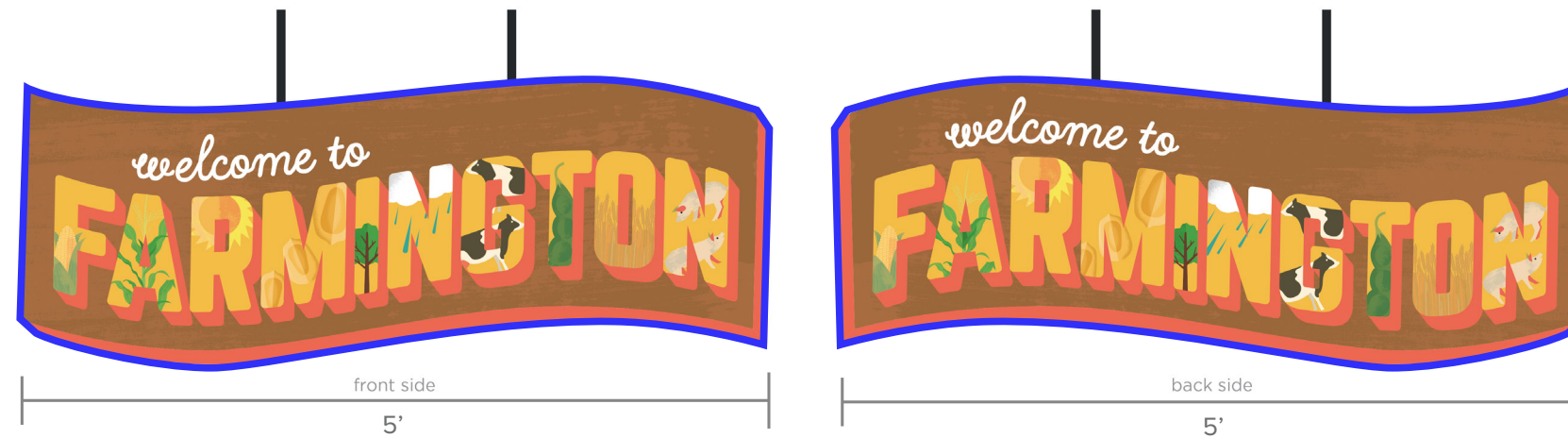

Summary/ Experience Description

Winfield Room 5, overviews and individual pieces for fabrication.

Technology Description

Build out, fabrication and installations.

Scope of Work

Specialty Fabrication, Signage, Wall and Floor Decal, Construction, Multi-media, AV/Data, etc.



1234 Main St., Green Bay, WI
920.430.7200
cineviz.com

LAYOUT & MATERIALS PLAN

Client:
Winfield Room 6

Project Number & Name:
365 - WINFI - CROP Adventure - Room 6 - From the Farm to You

Job Number & Exhibit Description:
15410 All Schematics for Room 6

Proof Date: 11-12-15

Return Date: 11-18-15

Notes:

- Fabricated sign with name of the “town”.
- Two sided sign.
- Suspended from the ceiling.

Scale: NTS

Version: 1.5

Designer: sb

Routing Sheet

SENDING:

- Attached Shop Drawings Prints Plans Samples
- Copy Change Order Specifications
- Other:

PURPOSE:

- For Approval & Execution Resubmit Copies for Approval Returned for Corrections
- For Your Use Approved as Noted As Requested
- Return Corrected Prints For Review & Comment

REMARKS/NOTES



1234 Main St., Green Bay, WI
920.430.7200
cineviz.com

LAYOUT & MATERIALS PLAN

Client:
Winfield Room 6

Project Number & Name:
365 - WINFI - CROP Adventure - Room 6 - From the Farm to You

Job Number & Exhibit Description:
15410 All Schematics for Room 6

Proof Date: 11-12-15

Return Date: 11-18-15

Notes:

Summary/ Experience Description

Winfield Room 5, overviews and individual pieces for fabrication.

Technology Description

Build out, fabrication and installations.

Scope of Work

Specialty Fabrication, Signage, Wall and Floor Decal, Construction, Multi-media, AV/Data, etc.

Scale: NTS

Version: 1.5

Designer: sb

Signature



LAYOUT & MATERIALS PLAN

Client:
Winfield Room 6

Project Number & Name:
365 - WINFI - CROP Adventure - Room 6 - From the Farm to You

Job Number & Exhibit Description:
15410 All Schematics for Room 6

Proof Date: **11-12-15**

Return Date: **11-18-15**

Notes:

Summary/ Experience Description

Winfield Room 5, overviews and individual pieces for fabrication.

Technology Description

Build out, fabrication and installations.

Scope of Work

Specialty Fabrication, Signage, Wall and Floor Decal, Construction, Multi-media, AV/Data, etc.

Scale: NTS

Version: 1.5

Designer: sb